

MAST SPECIFICATIONS and RATED CAPACITIES

B15NS

| Model | Mast Type | Max. Fork Height mm | Mast Lowered Height mm | Extended Height | Free lift | Tilt Angle | | Load capacities |
|-------|-----------|------------------------|---------------------------|------------------|------------------|------------|-----|-----------------|
| | | | | w/ Load Backrest | w/ Load Backrest | Fwd | Bwd | LC 500mm |
| | | | | mm | mm | deg | deg | kg |
| B15NS | STD | 3,000 | 1,997 | 3,981 | 125 | 6 | 10 | 1,500 |
| | | 3,300 | 2,147 | 4,281 | 125 | 6 | 10 | 1,500 |
| | | 3,500 | 2,247 | 4,481 | 125 | 6 | 10 | 1,500 |
| | FFT | 4,500 | 2,120 | 5,479 | 1,163 | 6 | 6 | 1,300 |
| | | 4,800 | 2,220 | 5,779 | 1,263 | 6 | 6 | 1,100 |

B18NS

| Model | Mast Type | Max. Fork Height mm | Mast Lowered Height mm | Extended Height | Free lift | Tilt Angle | | Load capacities |
|-------|-----------|------------------------|---------------------------|------------------|------------------|------------|-----|-----------------|
| | | | | w/ Load Backrest | w/ Load Backrest | Fwd | Bwd | LC 500mm |
| | | | | mm | mm | deg | deg | kg |
| B18NS | STD | 3,000 | 1,997 | 3,981 | 125 | 6 | 10 | 1,750 |
| | | 3,300 | 2,147 | 4,281 | 125 | 6 | 10 | 1,750 |
| | | 3,500 | 2,247 | 4,481 | 125 | 6 | 10 | 1,750 |
| | FFT | 4,500 | 2,120 | 5,479 | 1,163 | 6 | 6 | 1,500 |
| | | 4,800 | 2,220 | 5,779 | 1,263 | 6 | 6 | 1,300 |

B20NSC

| Model | Mast Type | Max. Fork Height mm | Mast Lowered Height mm | Extended Height | Free lift | Tilt Angle | | Load capacities |
|--------|-----------|------------------------|---------------------------|------------------|------------------|------------|-----|-----------------|
| | | | | w/ Load Backrest | w/ Load Backrest | Fwd | Bwd | LC 500mm |
| | | | | mm | mm | deg | deg | kg |
| B20NSC | STD | 3,000 | 2,059 | 3,981 | 110 | 6 | 10 | 2,000 |
| | | 3,300 | 2,209 | 4,281 | 110 | 6 | 10 | 2,000 |
| | | 3,500 | 2,309 | 4,481 | 110 | 6 | 10 | 2,000 |
| | FFT | 4,500 | 2,159 | 5,479 | 1,209 | 6 | 6 | 1,600 |
| | | 4,800 | 2,259 | 5,779 | 1,309 | 6 | 6 | 1,400 |

Note : Mast Specifications & Rated capacities are based on standard chassis without side shifter.



B15NS/B18NS/B20NSC

NXE SERIES FORKLIFTS

Electric 1.5 to 2.0 tonne capacity 4-wheel



B25NS-200831ENV1 (August 2020)



Doosan Industrial Vehicle UK
12 Kilvey Road
Northampton
NN4 7BQ
Tel: 01604 825 600
Website: www.doosanift.com

Authorized Dealer

| | | | | | | DOOSAN | DOOSAN | DOOSAN |
|-----------------|---------------------------|--|---|-----------|------------------|-----------------|-----------------|-----------------|
| | | | | | | | | |
| Characteristics | 1.1 | Manufacturer | | | | DOOSAN | DOOSAN | DOOSAN |
| | 1.2 | Manufacturer's type designation | | | | B15NS | B18NS | B20NSC |
| | 1.3 | Drive | | | | Electric | Electric | Electric |
| | 1.4 | Operator type | | | | Seated | Seated | Seated |
| | 1.5 | Load capacity/rated load kg(lb) | kg | Q | | 1,500 | 1,750 | 2,000 |
| | 1.6 | Load centre distance | mm | c | | 500 | 500 | 500 |
| | 1.8 | Load distance, centre of drive axle to fork | mm | x | | 391 | 391 | 396 |
| | 1.9 | Wheelbase | mm | y | | 1,360 | 1,360 | 1,360 |
| | Weight | 2.1 | Service weight (with min. weight of battery) | kg | | | 3,020 | 3,300 |
| 2.2 | | Axle loading, loaded front/rear | kg | | | 4,035/485 | 4,535/515 | 4,950/570 |
| 2.3 | | Axle loading, unloaded front/rear | kg | | | 1,495/1,525 | 1,560/1,740 | 1,620/1,900 |
| Tyres | 3.1 | Tires: pneumatic (P), superelastic (SE), cushion (C) SE | | | | SE | SE | SE |
| | 3.2 | Tire size, front | | | | 6.5-10-10 | 6.5-10-10 | 6.5-10-10 |
| | 3.3 | Tire size, rear | | | | 5.00-8-10 | 5.00-8-10 | 5.00-8-10 |
| | 3.5 | Wheels, number front/rear (x=driven wheels) | | | | 2X/2 | 2X/2 | 2X/2 |
| | 3.6 | Tread width, front | mm | b10 | | 970 | 970 | 970 |
| | 3.7 | Tread width, rear | mm | b11 | | 920 | 920 | 920 |
| | Dimensions | 4.1 | Tilt of mast/fork carriage forward (α)/backward(β) | deg | α / β | | 6/10 | 6/10 |
| 4.2 | | Height, mast lowered | mm | h1 | | 1,997 | 1,997 | 2,059 |
| 4.3 | | Free lift | mm | h2 | | 125 | 125 | 110 |
| 4.4 | | Lift (with STD 2-stage mast) | mm | h3 | | 3,000 | 3,000 | 3,000 |
| 4.5 | | Height, mast extended | mm | h4 | | 3,981 | 3,981 | 3,981 |
| 4.7 | | Height to top of overhead guard | mm | h6 | | 2,100 | 2,100 | 2,100 |
| 4.8 | | Seat height/stand height | mm | h7 | | 1060 | 1060 | 1060 |
| 4.12 | | Towing coupling height | mm | h10 | | 290 | 290 | 290 |
| 4.19 | | Overall length | mm | l1 | | 3,122 | 3,122 | 3,175 |
| 4.2 | | Length to face of forks | mm | l2 | | 2,052 | 2,052 | 2,105 |
| 4.21 | | Overall width | mm | b1 | | 1,150 | 1,150 | 1,150 |
| 4.22 | | Fork dimensions | mm | s / e / l | | 35/100/1,070 | 35/100/1,070 | 40/100/1,070 |
| 4.23 | | Fork carriage ISO 2328. Class/type A, B | | | | II A | II A | II A |
| 4.24 | | Fork carriage width | mm | b3 | | 1,040 | 1,040 | 1,040 |
| 4.24a | | Fork Spacing (min/max) | mm | | | 200/1040 | 200/1040 | 240/1040 |
| 4.31 | | Ground clearance, with load, below mast | mm | m1 | | 100 | 100 | 100 |
| 4.32 | | Ground clearance, centre of wheelbase | mm | m2 | | 105 | 105 | 105 |
| 4.34.1 | | Aisle width for pallets 1,000 x 1,200 crossways | mm | Ast | | 3,481 | 3,481 | 3,526 |
| 4.34.1 | | Aisle width for pallets 800 x 1,200 lengthways | mm | Ast | | 3,681 | 3,681 | 3,726 |
| 4.35 | | Turning radius | mm | Wa | | 1,890 | 1,890 | 1,930 |
| 4.36 | Internal turning radius | mm | b13 | | 575 | 575 | 575 | |
| Performance | 5.1 | Travel speed, loaded / unloaded | km/h | | | 13/15 | 13/15 | 13/15 |
| | 5.2 | Lift speed, loaded / unloaded | mm/s | | | 380/440 | 350/440 | 350/440 |
| | 5.3 | Lowering speed, loaded / unloaded | mm/s | | | 450/500 | 460/500 | 470/500 |
| | 5.6 | Maximum drawbar pull, loaded / unloaded, 5 minute rating | N | | | 12,000 / 13,000 | 13,000 / 14,000 | 13,500 / 14,500 |
| | 5.8 | Maximum gradeability, loaded / unloaded, 5 minute rating | % | | | 13 / 15 | 13 / 15 | 13 / 15 |
| | 5.10 | Service brake | | | | FOOT / HYD | FOOT / HYD | FOOT / HYD |
| | Parking brake | | | | AUTO / EM | AUTO / EM | AUTO / EM | |
| Electric engine | 6.1 | Drive motor rating S2 60 minute | kW | | | 8 | 8 | 8 |
| | 6.2 | Lifting motor rating at S3 15% | kW | | | 11 | 11 | 11 |
| | 6.3 | Battery type | | | | Lead-acid | Lead-acid | Lead-acid |
| | 6.4 | Battery voltage/nominal capacity K | V/Ah | | | 48/400 | 48/400 | 48/400 |
| | 6.5 | Battery weight | kg | | | 660 | 660 | 660 |
| | Battery Compartment L/W/H | mm | | | 398 / 980 / 760 | 398 / 980 / 760 | 398 / 980 / 760 | |

DIMENSIONAL DRAWING

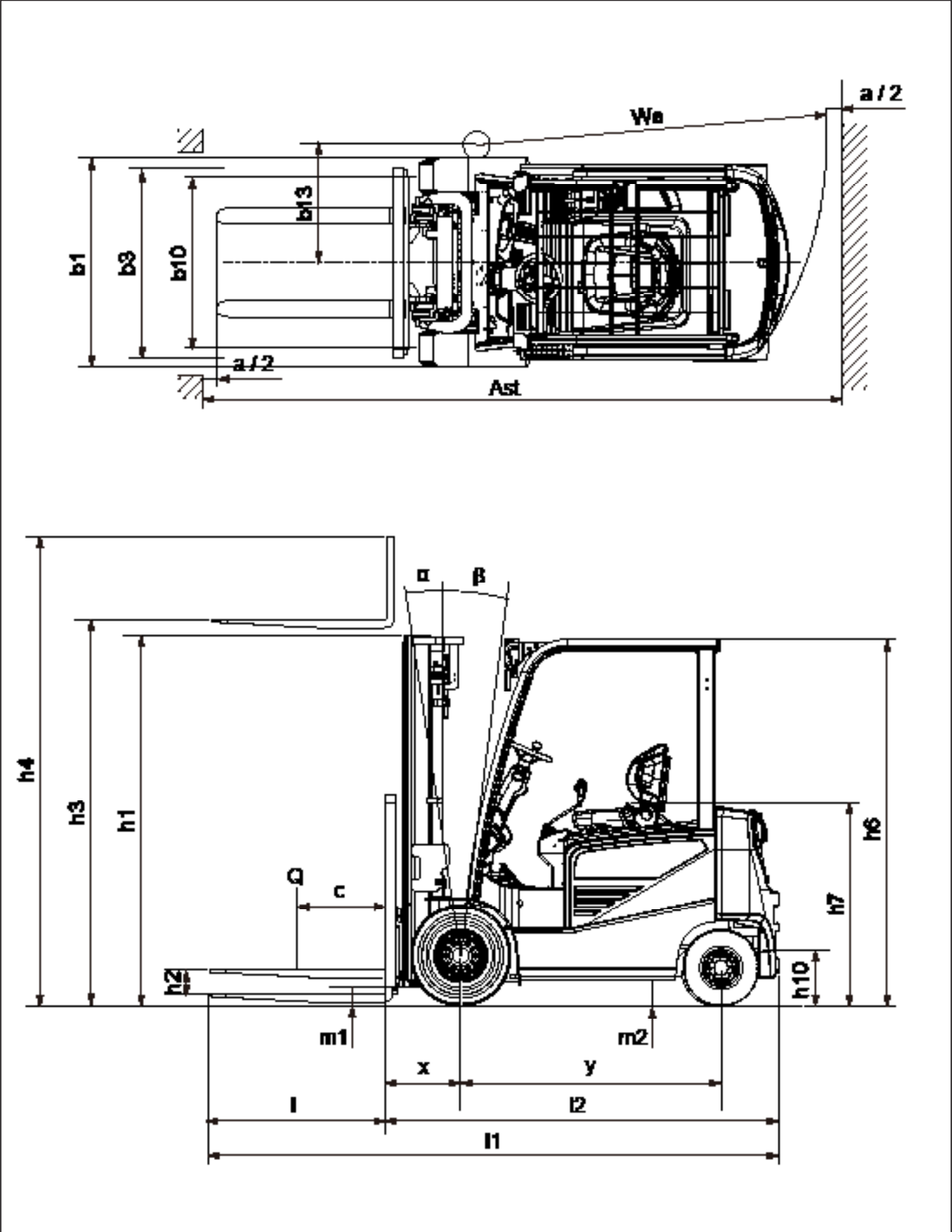

Note : Specification values quoted in this specification sheet have been rounded. Performance may vary due to operation conditions. Products and specifications are subject to improvement and change without prior notices.



B15T-7 PLUS / B18T-7 PLUS / B20T-7 PLUS

7 PLUS SERIES FORKLIFTS

Electric 1.5 to 2.0 tonne capacity
3 wheel



GENERAL SPECIFICATION

| CHARACTERISTICS | | | | | | | | |
|-----------------|---|--|---------------------------------|-------------------------------------|-------------------------------------|-------------------------------------|-------------------------------------|-------------------------------------|
| 2 | Model | | | | B15T-7 PLUS | B18T-7 PLUS | B20T-7 PLUS | |
| 3 | Load Capacity | at rated load center | | kg | 1500 | 1750 | 2000 | |
| 4 | Load center | | | mm | 500 | 500 | 500 | |
| 5 | Power type | | | | AC Electric | AC Electric | AC Electric | |
| 6 | Operator type | | | | Driver Seated | Driver Seated | Driver Seated | |
| 7 | Tire Type | P : Pneumatic, E : Solid Soft, C : Cushion | | | E, C | E, C | E, C | |
| 8 | Wheels (x=Driven) | Number of front / rear | | | x 2 / 2 | x 2 / 2 | x 2 / 2 | |
| DIMENSIONS | | | | | | | | |
| 9 | Max.Fork Height | with STD 2-stage mast | | mm | 3300 | 3300 | 3300 | |
| 10 | Free Lift | | | mm | 130 | 130 | 135 | |
| 12 | Fork carriage | ISO Class | | | CLASS II | CLASS II | CLASS II | |
| 13 | Fork | Thickness x Width x Length | | mm | 35 x 100 x 900 | 35 x 100 x 900 | 40 x 100 x 900 | |
| | | Fork Spacing (Min. x Max.) | | mm | 240 x 905 | 240 x 905 | 240 x 905 | |
| 14 | Tilt of Mast | Forward / Backward | | deg | 5/7 | 5/7 | 5/7 | |
| 15 | Overall Dimensions | Length to Fork Face | | mm | 1891 | 1991 | 2029 | |
| 16 | | Overall Width | | mm | 1090 | 1090 | 1119 | |
| 17 | | Mast Lowered Height | | mm | 2000 | 2000 | 2000 | |
| 18 | | Mast Extended Height | | mm | 4345 | 4345 | 4350 | |
| 19 | | Overhead Guard Height | | mm | 2010 | 2010 | 2010 | |
| 20 | Seat Height | | mm | 919 | 919 | 919 | | |
| 21 | Outer Turning Radius | | mm | 1515 | 1615 | 1648 | | |
| | Inner Turning Radius | | mm | 0 | 0 | 0 | | |
| 22 | Load Moment Center | Center of drive axle to fork face | | mm | 376 | 376 | 381 | |
| 23 | Right Angle Stacking Aisle Width (With Pallets & Clearance) | Pallet 1000 x 1200 crossways | | mm | 3216 | 3316 | 3354 | |
| | | Pallet 800 x 1200 lengthways | | mm | 3341 | 3441 | 3479 | |
| PERFORMANCE | | | | | | | | |
| 24 | Speed | Travel | Loaded / Unloaded | km/h | 17 / 17 | 17 / 17 | 17 / 17 | |
| | | Lifting | Loaded / Unloaded | mm/s | 400 / 600 | 400 / 600 | 400 / 600 | |
| | | Lowering | Loaded / Unloaded | mm/s | 500 / 450 | 500 / 450 | 500 / 450 | |
| 28 | Max. Drawbar pull | Loaded at 1.6km/h | | kg | 1300 | 1300 | 1300 | |
| 30 | Max. Gradeability | Loaded at 1.6km/h | | % | 26 | 25 | 24 | |
| WEIGHT | | | | | | | | |
| 32 | Total weight | with min. weight of battery | | kg | 3028 | 3142 | 3472 | |
| 33 | Axle Load | Loaded , Front / Rear | | kg | 3988 / 540 | 4358 / 534 | 4841 / 631 | |
| 34 | | Unloaded , Front / Rear | | kg | 1495 / 1533 | 1530 / 1612 | 1623 / 1849 | |
| CHASSIS | | | | | | | | |
| 35 | | | Number of Wheels (Front / Rear) | | | 2 / 2 | 2 / 2 | |
| 36 | Tires | Size | | Front | 18x7-8 ¹⁾ | 18x7-8 ¹⁾ | 200x50-10 ¹⁾ | |
| | | Rear | | | 15x4.5-8 ²⁾ | 15x4.5-8 ²⁾ | 16x6-8 ²⁾ | |
| 38 | Wheel Base | Distance | | mm | 1323 | 1423 | 1446 | |
| 39 | Tread Width | Front | | mm | 902 | 902 | 912 | |
| | | Rear | | mm | 167 | 167 | 201 | |
| 40 | Ground clearance | Loaded | at lowest | | mm | 86 | 86 | |
| 41 | | | at center of wheel base | | mm | 100 | 100 | |
| 42 | Brakes | Service | | | Foot-Electric | Foot-Electric | Foot-Electric | |
| 43 | | Parking | | | Auto-Electric | Auto-Electric | Auto-Electric | |
| POWER TRAIN | | | | | | | | |
| 45 | Battery | Type | | | Lead-acid | Lead-acid | Lead-acid | |
| | | Voltage | | V | 48 | 48 | 48 | |
| | | Capacity (5 Hours Rating) | Normal | BS type | AH | 440 | 510 | 585 |
| | | | | DIN type | AH | 460 | 525 | 575 |
| | | | Max. | BS type | AH | 575 | 690 | 690 |
| | | | | DIN type | AH | 500 | 625 | 625 |
| | | Battery compartment sizes* (L x W x H) | | Normal | mm | 528 x 992 x 698 | 638 x 992 x 698 | 638 x 992 x 698 |
| | | | | BS type | mm | 528 x 992 x 698 | 638 (608) ³⁾ x 992 x 698 | 638 (608) ³⁾ x 992 x 698 |
| DIN type | mm | | | 528 x 992 (842) ⁴⁾ x 698 | 638 x 992 (842) ⁴⁾ x 698 | 638 x 992 (842) ⁴⁾ x 698 | | |
| Min. Weight | | kg | 700 | 800 | 1000 | | | |
| 47 | Electric Motors | Drive motor rating at S2 60 minute | | kW | 6.0 x 2 | 6.0 x 2 | 6.0 x 2 | |
| | | Lifting motor rating at S3 15% | | kW | 14 | 14 | 14 | |
| 54 | Control Type | Drive and Hydraulic | | Type | MOSFET Inverter | MOSFET Inverter | MOSFET Inverter | |
| 55 | Drive Axle | Brake Type | | Type | E-Motor | E-Motor | E-Motor | |
| 57 | Relief Pressure | System | | kpa | 17600 | 19900 | 21600 | |
| | | Attachment | | kpa | 14000 | 14000 | 14000 | |

1) Optional: cushion Tires_18 x 7 - 12.12

2) Optional: cushion Tires_15 x 6 - 11.25

3) If the operator is using a BS Type Battery (608mm length/ 575, 630, 690AH/5h capacity), special accessory (stopper) should be chosen.

4) If the operator is using a DIN Type Battery (842mm width), special accessory (bracket) should be chosen.

*Please refer to the technical bulletin and contact your Doosan representative for more detailed information of the battery size. This specification sheet to VDI guideline 2198 only gives the technical figures for the standard truck. Different tires, other masts, additional equipment etc. could give different figures.

DIMENSIONAL DRAWING

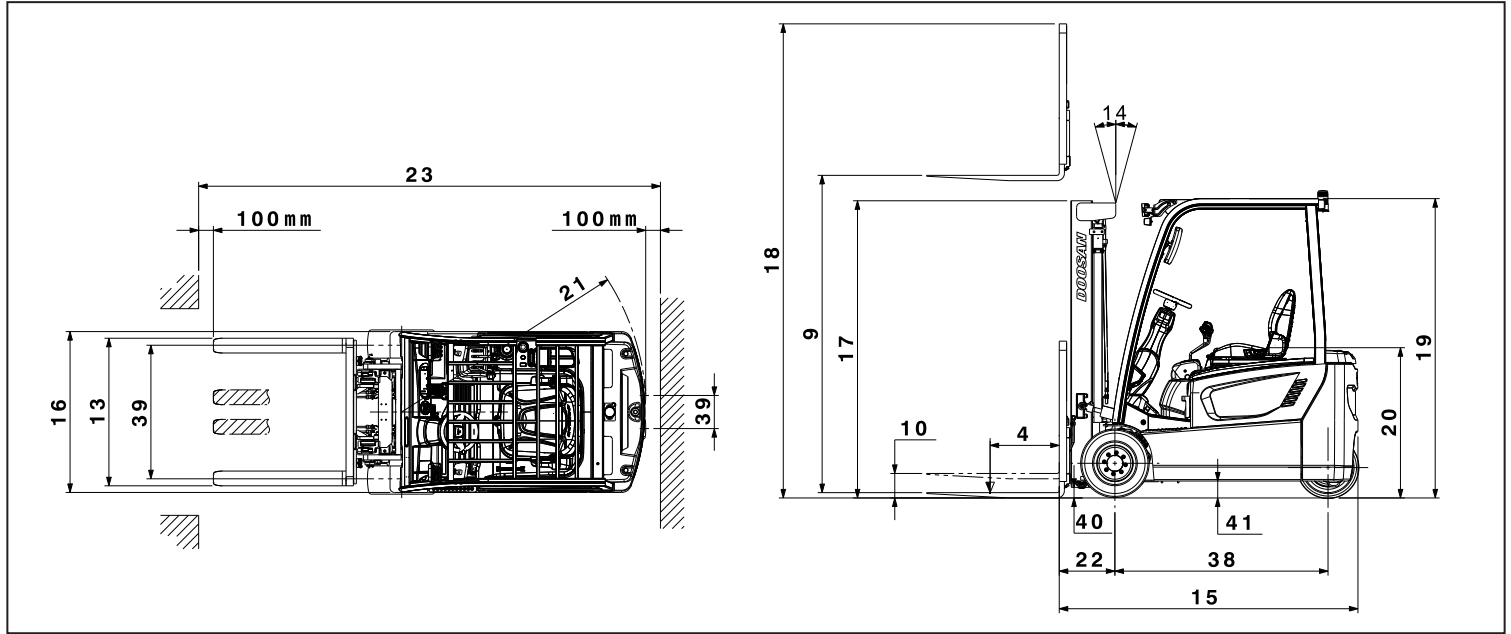

MAST SPECIFICATIONS and RATED CAPACITIES

B15T-7 PLUS

| Mast Type | Maximum Fork Height | Maximum Lowered Height | Extended Height | | Free Lift | | Solid Soft Tire | | Cushion Tire | |
|-----------|---------------------|------------------------|------------------|-------------------|------------------|-------------------|-----------------|---------------|--------------|---------------|
| | | | w/ Load Backrest | w/o Load Backrest | w/ Load Backrest | w/o Load Backrest | Tilt Angle | Load Capacity | Tilt Angle | Load Capacity |
| | | | mm | mm | mm | mm | FWD/BWD | LC 500mm | FWD/BWD | LC 500mm |
| STD | 3000 | 2000 | 4045 | 3600 | 130 | 130 | 5/7 | 1500 | 5/7 | 1500 |
| | 3300 | 2150 | 4345 | 3900 | 130 | 130 | 5/7 | 1500 | 5/7 | 1500 |
| | 3500 | 2250 | 4545 | 4100 | 130 | 130 | 5/7 | 1500 | 5/7 | 1500 |
| | 3700 | 2350 | 4745 | 4300 | 130 | 130 | 5/7 | 1500 | 5/7 | 1500 |
| | 4000 | 2550 | 5045 | 4600 | 130 | 130 | 5/7 | 1500 | 5/7 | 1500 |
| FF | 2700 | 1850 | 3745 | 3325 | 845 | 1265 | 5/5 | 1500 | 5/5 | 1500 |
| | 3000 | 2000 | 4045 | 3625 | 995 | 1415 | 5/5 | 1500 | 5/5 | 1500 |
| | 3300 | 2150 | 4345 | 3925 | 1145 | 1565 | 5/5 | 1500 | 5/5 | 1500 |
| FFT | 4000 | 1880 | 5050 | 4630 | 875 | 1295 | 5/5 | 1450 | 5/5 | 1475 |
| | 4500 | 2045 | 5545 | 5125 | 1040 | 1460 | 5/5 | 1400 | 5/5 | 1425 |
| | 4750 | 2130 | 5795 | 5375 | 1125 | 1545 | 5/5 | 1350 | 5/5 | 1375 |
| | 5000 | 2245 | 6045 | 5625 | 1240 | 1660 | 5/5 | 1300 | 5/5 | 1350 |
| | 5500 | 2480 | 6550 | 6130 | 1475 | 1895 | 5/5 | 975 | 5/5 | 1275 |
| | 6000 | 2645 | 7045 | 6625 | 1640 | 2060 | 5/5 | 650 | 5/5 | 1225 |

B18T-7 PLUS

| Mast Type | Maximum Fork Height | Maximum Lowered Height | Extended Height | | Free Lift | | Solid Soft Tire | | Cushion Tire | |
|-----------|---------------------|------------------------|------------------|-------------------|------------------|-------------------|-----------------|---------------|--------------|---------------|
| | | | w/ Load Backrest | w/o Load Backrest | w/ Load Backrest | w/o Load Backrest | Tilt Angle | Load Capacity | Tilt Angle | Load Capacity |
| | | | mm | mm | mm | mm | FWD/BWD | LC 500mm | FWD/BWD | LC 500mm |
| STD | 3000 | 2000 | 4045 | 3600 | 130 | 130 | 5/7 | 1750 | 5/7 | 1750 |
| | 3300 | 2150 | 4345 | 3900 | 130 | 130 | 5/7 | 1750 | 5/7 | 1750 |
| | 3500 | 2250 | 4545 | 4100 | 130 | 130 | 5/7 | 1750 | 5/7 | 1750 |
| | 3700 | 2350 | 4745 | 4300 | 130 | 130 | 5/7 | 1750 | 5/7 | 1750 |
| | 4000 | 2550 | 5045 | 4600 | 130 | 130 | 5/7 | 1750 | 5/7 | 1750 |
| FF | 2700 | 1850 | 3745 | 3325 | 845 | 1265 | 5/5 | 1750 | 5/5 | 1750 |
| | 3000 | 2000 | 4045 | 3625 | 995 | 1415 | 5/5 | 1750 | 5/5 | 1750 |
| | 3300 | 2150 | 4345 | 3925 | 1145 | 1565 | 5/5 | 1750 | 5/5 | 1750 |
| FFT | 4000 | 1880 | 5050 | 4630 | 875 | 1295 | 5/5 | 1675 | 5/5 | 1700 |
| | 4500 | 2045 | 5545 | 5125 | 1040 | 1460 | 5/5 | 1600 | 5/5 | 1650 |
| | 4750 | 2130 | 5795 | 5375 | 1125 | 1545 | 5/5 | 1525 | 5/5 | 1625 |
| | 5000 | 2245 | 6045 | 5625 | 1240 | 1660 | 5/5 | 1400 | 5/5 | 1575 |
| | 5500 | 2480 | 6550 | 6130 | 1475 | 1895 | 5/5 | 1025 | 5/5 | 1500 |
| | 6000 | 2645 | 7045 | 6625 | 1640 | 2060 | 5/5 | 700 | 5/5 | 1400 |

Note : These load capacities are based on the standard chassis without side shifter.

Specification values quoted in this specification sheet has been rounded. Performance may vary due to operation conditions. Products and specifications are subject to improvement and change without prior notices.

B20T-7 PLUS

| Mast Type | Maximum Fork Height | Maximum Lowered Height | Extended Height | | Free Lift | | Solid Soft Tire | | Cushion Tire | |
|-----------|---------------------|------------------------|------------------|-------------------|------------------|-------------------|-----------------|---------------|--------------|---------------|
| | | | w/ Load Backrest | w/o Load Backrest | w/ Load Backrest | w/o Load Backrest | Tilt Angle | Load Capacity | Tilt Angle | Load Capacity |
| | | | mm | mm | mm | mm | FWD/BWD | LC 500mm | FWD/BWD | LC 500mm |
| STD | 3000 | 2000 | 4050 | 3605 | 135 | 135 | 5/7 | 2000 | 5/7 | 2000 |
| | 3300 | 2150 | 4350 | 3905 | 135 | 135 | 5/7 | 2000 | 5/7 | 2000 |
| | 3500 | 2250 | 4550 | 4105 | 135 | 135 | 5/7 | 2000 | 5/7 | 2000 |
| | 3700 | 2350 | 4750 | 4305 | 135 | 135 | 5/7 | 2000 | 5/7 | 2000 |
| | 4000 | 2550 | 5050 | 4605 | 135 | 135 | 5/7 | 2000 | 5/7 | 2000 |
| | 4500 | 2800 | 5550 | 5105 | 135 | 135 | 5/7 | 1950 | 5/7 | 2000 |
| FF | 2700 | 1850 | 3750 | 3330 | 845 | 1265 | 5/5 | 2000 | 5/5 | 2000 |
| | 3000 | 2000 | 4050 | 3630 | 995 | 1415 | 5/5 | 2000 | 5/5 | 2000 |
| | 3300 | 2150 | 4350 | 3930 | 1145 | 1565 | 5/5 | 2000 | 5/5 | 2000 |
| FFT | 4000 | 1880 | 5055 | 4635 | 875 | 1295 | 5/5 | 1950 | 5/5 | 2000 |
| | 4500 | 2045 | 5550 | 5130 | 1040 | 1460 | 5/5 | 1875 | 5/5 | 1975 |
| | 4750 | 2130 | 5800 | 5380 | 1125 | 1545 | 5/5 | 1825 | 5/5 | 1925 |
| | 5000 | 2245 | 6050 | 5630 | 1240 | 1660 | 5/5 | 1800 | 5/5 | 1900 |
| | 5500 | 2480 | 6555 | 6135 | 1475 | 1895 | 5/5 | 1700 | 5/5 | 1800 |
| | 6000 | 2645 | 7050 | 6630 | 1640 | 2060 | 5/5 | 1575 | 5/5 | 1500 |

Note : These load capacities are based on the standard chassis without side shifter.



Doosan Industrial Vehicle UK
 12 Kilvey Road, Brackmills Ind
 Estate Northampton, NN4 7BQ
 Tel: 01604 825600
 Website: www.doosanflt.com

2021 JUNE

AUTHORIZED DEALER

B15R-7

| Mast type | Max. Fork Height | Mast Lowered Height | Extended Height | Free Lift | Tilt Angle | | Soild Soft Tire Load Capacities | Pneumatic Tire Load Capacities |
|-----------|------------------|---------------------|------------------|------------------|------------|----------|---------------------------------|--------------------------------|
| | | | w/ Load Backrest | w/ Load Backrest | Forward | Backward | LC 500mm | LC 500mm |
| | mm | mm | mm | mm | deg | deg | kg | kg |
| STD | 3,000 | 2,025 | 4,045 | 130 | 3 | 8 | 1,500 | 1,500 |
| | 3,300 | 2,175 | 4,345 | 130 | 3 | 6 | 1,500 | 1,500 |
| | 3,500 | 2,275 | 4,545 | 130 | 3 | 6 | 1,500 | 1,500 |
| | 3,700 | 2,375 | 4,745 | 130 | 3 | 6 | 1,500 | 1,500 |
| | 4,000 | 2,575 | 5,045 | 130 | 3 | 6 | 1,475 | 1,500 |
| | 4,500 | 2,825 | 5,545 | 130 | 3 | 6 | 1,400 | 1,400 |
| FF | 2,700 | 1,875 | 3,745 | 870 | 3 | 5 | 1,500 | 1,500 |
| | 3,000 | 2,025 | 4,045 | 1,020 | 3 | 5 | 1,500 | 1,500 |
| | 3,300 | 2,175 | 4,345 | 1,170 | 3 | 5 | 1,500 | 1,500 |
| FFT | 4,000 | 1,905 | 5,050 | 900 | 3 | 5 | 1,450 | 1,500 |
| | 4,500 | 2,070 | 5,545 | 1,065 | 3 | 5 | 1,375 | 1,425 |
| | 4,750 | 2,155 | 5,795 | 1,150 | 3 | 5 | 1,350 | 1,375 |
| | 5,000 | 2,270 | 6,045 | 1,265 | 3 | 5 | 1,200 | 1,000 |
| | 5,500 | 2,505 | 6,550 | 1,500 | 3 | 5 | 900 | 700 |
| | 6,000 | 2,670 | 7,045 | 1,665 | 3 | 5 | 600 | 475 |

B16R-7

| Mast type | Max. Fork Height | Mast Lowered Height | Extended Height | Free Lift | Tilt Angle | | Soild Soft Tire Load Capacities |
|-----------|------------------|---------------------|------------------|------------------|------------|----------|---------------------------------|
| | | | w/ Load Backrest | w/ Load Backrest | Forward | Backward | LC 500mm |
| | mm | mm | mm | mm | deg | deg | kg |
| STD | 3,000 | 2,025 | 4,045 | 130 | 3 | 6 | 1,600 |
| | 3,300 | 2,175 | 4,345 | 130 | 3 | 6 | 1,600 |
| | 3,500 | 2,275 | 4,545 | 130 | 3 | 6 | 1,600 |
| | 3,700 | 2,375 | 4,745 | 130 | 3 | 6 | 1,600 |
| | 4,000 | 2,575 | 5,045 | 130 | 3 | 6 | 1,575 |
| | 4,500 | 2,825 | 5,545 | 130 | 3 | 6 | 1,500 |
| FF | 2,700 | 1,875 | 3,745 | 870 | 3 | 5 | 1,600 |
| | 3,000 | 2,025 | 4,045 | 1,020 | 3 | 5 | 1,600 |
| | 3,300 | 2,175 | 4,345 | 1,170 | 3 | 5 | 1,600 |
| FFT | 4,000 | 1,905 | 5,050 | 900 | 3 | 5 | 1,550 |
| | 4,500 | 2,070 | 5,545 | 1,065 | 3 | 5 | 1,500 |
| | 4,750 | 2,155 | 5,795 | 1,150 | 3 | 5 | 1,450 |
| | 5,000 | 2,270 | 6,045 | 1,265 | 3 | 5 | 1,300 |
| | 5,500 | 2,505 | 6,550 | 1,500 | 3 | 5 | 875 |
| | 6,000 | 2,670 | 7,045 | 1,665 | 3 | 5 | 575 |

Note : These load capacities are based on the standard chassis without side shifter.
Products and specifications are subject to improvement and change without prior notices.

B16R-7-190110ENV1 (January 2019)



Doosan Industrial Vehicles UK LTD
12 Kilvey Road
Brackmills Industrial Estate
Northampton
NN4 7BQ

Tel.: 01604 825 600
Website : www.doosanflt.com

AUTHORIZED DEALER



B13R-7 / B15R-7 / B16R-7

7-SERIES FORKLIFTS

Electric 1.25 to 1.6 tonne capacity



Technical Data according to VDI 2198

| CHARACTERISTICS | 1.1 | Manufacturer | | | Doosan | Doosan | Doosan |
|------------------|--|--|--|-----------|-----------------------|-----------------------|-----------------------|
| | 1.2 | Manufacturer's type designation | | | B13R-7 | B15R-7 | B16R-7 |
| | 1.3 | Drive | | | Electric | Electric | Electric |
| | 1.4 | Operator type | | | Seated | Seated | Seated |
| | 1.5 | Load capacity/rated load | kg | Q | 1,250 | 1,500 | 1,600 |
| | 1.6 | Load centre distance | mm | c | 500 | 500 | 500 |
| | 1.8 | Load distance, centre of drive axle to fork | mm | x | 330 | 330 | 330 |
| | 1.9 | Wheelbase (with forward/vertical/back mast) | mm | y | 1,112 x 1,145 x 1,195 | 1,171 x 1,195 x 1,245 | 1,171 x 1,195 x 1,245 |
| WEIGHT | 2.1 | Service weight (with min. weight of battery) | kg | | 2,827 | 3,001 | 3,086 |
| | 2.2 | Axle loading, loaded front/rear | kg | | 3,529/548 | 3,989/512 | 4,153/533 |
| | 2.3 | Axle loading, unloaded front/rear | kg | | 1,280/1,547 | 1,359/1,642 | 1,397/1,689 |
| TIRES | 3.1 | Tires: pneumatic (P), superelastic (SE), cushion (C) | | | P/SE | P/SE | SE |
| | 3.2 | Tire size, front | | | 18 x 7 - 8 | 18 x 7 - 8 | 18 x 7 - 8 |
| | 3.3 | Tire size, rear | | | 18 x 7 - 8 | 18 x 7 - 8 | 18 x 7 - 8 |
| | 3.5 | Wheels, number front/rear (x=driven wheels) | | | 2/1x | 2/1x | 2/1x |
| | 3.6 | Tread width, front | mm | b10 | 840 | 840 | 840 |
| | DIMENSIONS | 4.1 | Tilt of mast/fork carriage forward (α)/backward(β) | deg | α / β | 3/6 | 3/6 |
| 4.2 | | Height, mast lowered | mm | h1 | 2,025 | 2,025 | 2,025 |
| 4.3 | | Free lift | mm | h2 | 130 | 130 | 130 |
| 4.4 | | Maximum fork height | mm | h3 | 3,000 | 3,000 | 3,000 |
| 4.5 | | Height, mast extended | mm | h4 | 4,045 | 4,045 | 4,045 |
| 4.7 | | Height to top of overhead guard | mm | h6 | 2,067 | 2,067 | 2,067 |
| 4.8 | | Seat height/stand height | mm | h7 | 1,010 | 1,010 | 1,010 |
| 4.12 | | Towing coupling height | mm | h10 | 850 | 850 | 850 |
| 4.19 | | Overall length | mm | l1 | 2,645 | 2,670 | 2,695 |
| 4.20 | | Length to face of forks | mm | l2 | 1,745 | 1,770 | 1,795 |
| 4.21 | | Overall width | mm | b1 | 996 | 996 | 996 |
| 4.22 | | Fork dimensions | mm | s / e / l | 35 / 100 / 900 | 35 / 100 / 900 | 35 / 100 / 900 |
| 4.23 | | Fork carriage ISO 2328. Class/type A, B | | | II A | II A | II A |
| 4.24 | | Fork carriage width | mm | b3 | 1,000 | 1,000 | 1,000 |
| 4.24a | | Fork Spacing (min/max) | mm | | 200 / 905 | 200 / 905 | 200 / 905 |
| 4.31 | | Ground clearance, with load, below mast | mm | m1 | 60 | 60 | 60 |
| 4.32 | | Ground clearance, centre of wheelbase | mm | m2 | 90 | 90 | 90 |
| 4.33 | | Aisle width for pallets 1000 x 1200 crossways | mm | Ast | 3,074 | 3,099 | 3,124 |
| 4.34 | | Aisle width for pallets 800 x 1200 lengthways | mm | Ast | 3,196 | 3,221 | 3,246 |
| 4.35 | | Turning radius | mm | Wa | 1,415 | 1,440 | 1,465 |
| PERFORMANCE DATA | 5.1 | Travel speed, loaded / unloaded | km/h | | 12.0 / 13.0 | 12.0 / 12.5 | 12.0 / 12.5 |
| | 5.2 | Lift speed, loaded / unloaded | m/s | | 0.30 / 0.53 | 0.29 / 0.53 | 0.29 / 0.53 |
| | 5.3 | Lowering speed, loaded / unloaded | m/s | | 0.50 / 0.45 | 0.50 / 0.45 | 0.50 / 0.45 |
| | 5.6 | Maximum drawbar pull, loaded, 5 minute rating | N | | 9,623/9,623 | 9,623/9,623 | 9,623/9,623 |
| | 5.8 | Maximum gradeability, loaded, 5 minute rating | % | | 24/25 | 22/25 | 20/25 |
| | 5.10 | Service brake | | | FOOT / HYD | FOOT / HYD | FOOT / HYD |
| | | Parking brake | | | HAND / MECH | HAND / MECH | HAND / MECH |
| ELECTRIC ENGINE | 6.1 | Drive motor rating S2 60 minute | kW | | 6.5 | 6.5 | 6.5 |
| | 6.2 | Lifting motor rating at S3 15% | kW | | 9.0 | 9.0 | 9.0 |
| | 6.3 | Battery type | | | Lead-acid | Lead-acid | Lead-acid |
| | 6.4 | Battery voltage/nominal capacity K5 | V/Ah | | 24/875 | 24/1,000 | 24/1,000 |
| | 6.5 | Battery weight (min.) | kg | | 600 | 676 | 676 |
| | | Battery Compartment L/W/H | mm | | 445 x 836 x 627 | 445 x 836 x 627 | 445 x 836 x 627 |
| OTHERS | 8.1 | Type of drive control unit | | | Inverter AC | Inverter AC | Inverter AC |
| | 8.2 | Working press for attachments | bar | System | 159 | 175 | 175 |
| | | | Attachment | 140 | 140 | 140 | |
| 8.4 | Sound level at the driver's ear according to EN 12 053 | dB (A) | | | 63.7 | 63.7 | 63.7 |

DIMENSIONAL DRAWING

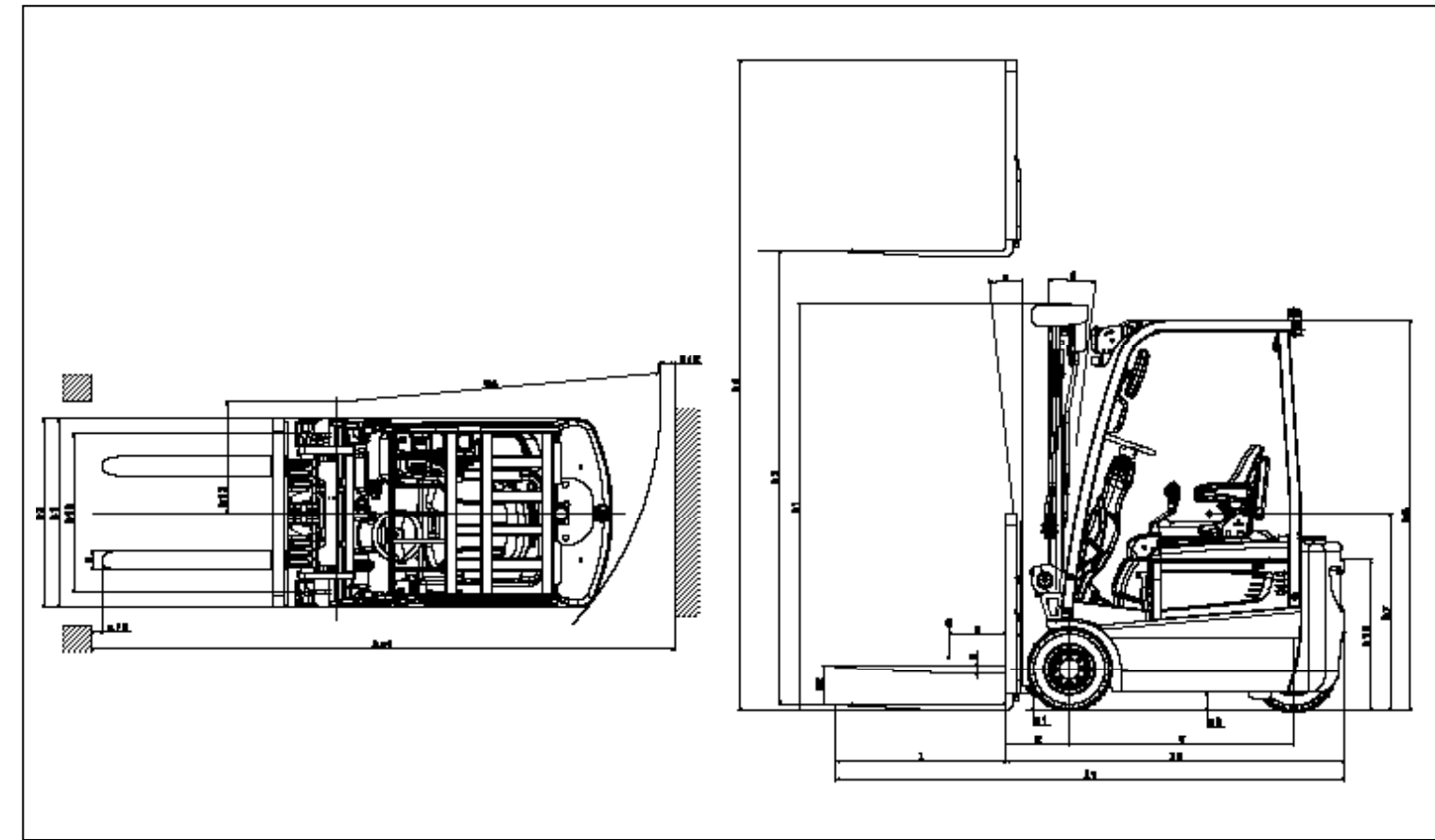

MAST SPECIFICATIONS and RATED CAPACITIES

B13R-7

| Mast type | Max. Fork Height | Mast Lowered Height | Extended Height | Free Lift | Tilt Angle | | Soild Soft Tire Load Capacities | Pneumatic Tire Load Capacities |
|-----------|------------------|---------------------|------------------|------------------|------------|----------|---------------------------------|--------------------------------|
| | | | w/ Load Backrest | w/ Load Backrest | Forward | Backward | LC 500mm | LC 500mm |
| | | | mm | mm | deg | deg | kg | kg |
| STD | 3,000 | 2,025 | 4,045 | 130 | 3 | 6 | 1,250 | 1,250 |
| | 3,300 | 2,175 | 4,345 | 130 | 3 | 6 | 1,250 | 1,250 |
| | 3,500 | 2,275 | 4,545 | 130 | 3 | 6 | 1,250 | 1,250 |
| | 3,700 | 2,375 | 4,745 | 130 | 3 | 6 | 1,250 | 1,250 |
| | 4,000 | 2,575 | 5,045 | 130 | 3 | 6 | 1,250 | 1,250 |
| FF | 2,700 | 1,875 | 3,745 | 870 | 3 | 5 | 1,250 | 1,250 |
| | 3,000 | 2,025 | 4,045 | 1,020 | 3 | 5 | 1,250 | 1,250 |
| | 3,300 | 2,175 | 4,345 | 1,170 | 3 | 5 | 1,250 | 1,250 |
| FFT | 4,000 | 1,905 | 5,050 | 900 | 3 | 5 | 1,250 | 1,250 |
| | 4,500 | 2,070 | 5,545 | 1,065 | 3 | 5 | 1,200 | 1,200 |
| | 4,750 | 2,155 | 5,795 | 1,150 | 3 | 5 | 1,175 | 1,175 |
| | 5,000 | 2,270 | 6,045 | 1,265 | 3 | 5 | 1,050 | 950 |
| | 5,500 | 2,505 | 6,550 | 1,500 | 3 | 5 | 850 | 650 |
| | 6,000 | 2,670 | 7,045 | 1,665 | 3 | 5 | 550 | 425 |

Note: Specification values quoted in this specification sheet have been rounded. Performance may vary depending on operating conditions. Products and specifications are subject to improvement and change without prior notice.

This specification sheet to VDI guideline 2198 only gives the technical figures for the standard truck. Different tires, other masts, additional equipment etc. could give different figures.



B16X-7 PLUS / B18X-7 PLUS / B20X-7 PLUS

7 PLUS SERIES FORKLIFTS

Electric 1.5 to 2.0 tonne capacity

4 wheel



GENERAL SPECIFICATION

| CHARACTERISTICS | | | | | | | | | |
|-----------------|---|--|-------------------------|-------------------------------------|-------------------------------------|-------------------------------------|-------------------------------------|-------------------------------------|--|
| 2 | Model | | | | B16X-7 PLUS | B18X-7 PLUS | B20X-7 PLUS | | |
| 3 | Load Capacity | at rated load center | | kg | 1600 | 1800 | 2000 | | |
| 4 | Load center | | | mm | 500 | 500 | 500 | | |
| 5 | Power type | | | | AC Electric | AC Electric | AC Electric | | |
| 6 | Operator type | | | | Driver Seated | Driver Seated | Driver Seated | | |
| 7 | Tire Type | P : Pneumatic, E : Solid Soft, C : Cushion | | | P, E | E | E | | |
| 8 | Wheels (x=Driven) | Number of front / rear | | | x 2 / 2 | x 2 / 2 | x 2 / 2 | | |
| DIMENSIONS | | | | | | | | | |
| 9 | Max.Fork Height | with STD 2-stage mast | | mm | 3300 | 3300 | 3300 | | |
| 10 | Free Lift | | | mm | 130 | 130 | 135 | | |
| 12 | Fork carriage | ISO Class | | | CLASS II | CLASS II | CLASS II | | |
| 13 | Fork | Thickness x Width x Length | | mm | 35 x 100 x 900 | 35 x 100 x 900 | 40 x 100 x 900 | | |
| | | Fork Spacing (Min. x Max.) | | mm | 240 x 905 | 240 x 905 | 240 x 905 | | |
| 14 | Tilt of Mast | Forward / Backward | | deg | 5/7 | 5/7 | 5/7 | | |
| 15 | Overall Dimensions | Length to Fork Face | | mm | 2120 | 2120 | 2125 | | |
| 16 | | Overall Width | | mm | 1090 | 1119 | 1119 | | |
| 17 | | Mast Lowered Height | | mm | 2150 | 2150 | 2150 | | |
| 18 | | Mast Extended Height | | mm | 4345 | 4345 | 4350 | | |
| 19 | | Overhead Guard Height | | mm | 2010 | 2010 | 2010 | | |
| 20 | Seat Height | | mm | 919 | 919 | 919 | | | |
| 21 | Outer Turning Radius | | mm | 1886 | 1886 | 1886 | | | |
| | Inner Turning Radius | | mm | 494 | 496 | 496 | | | |
| 22 | Load Moment Center | Center of drive axle to fork face | | mm | 376 | 376 | 381 | | |
| 23 | Right Angle Stacking Aisle Width (With Pallets & Clearance) | Pallet 1000 x 1200 crossways | | mm | 3466 | 3466 | 3471 | | |
| | | Pallet 800 x 1200 lengthways | | mm | 3662 | 3662 | 3667 | | |
| PERFORMANCE | | | | | | | | | |
| 24 | Speed | Travel | Loaded / Unloaded | km/h | 17 / 17 | 17 / 17 | 17 / 17 | | |
| 25 | | Lifting | Loaded / Unloaded | mm/s | 400 / 600 | 400 / 600 | 400 / 600 | | |
| 26 | | Lowering | Loaded / Unloaded | mm/s | 500 / 450 | 500 / 450 | 500 / 450 | | |
| 28 | Max. Drawbar pull | Loaded at 1.6km/h | | kg | 1300 | 1300 | 1300 | | |
| 30 | Max. Gradeability | Loaded at 1.6km/h | | % | 26 | 25 | 24 | | |
| WEIGHT | | | | | | | | | |
| 32 | Total weight | with min. weight of battery | | kg | 3189 | 3281 | 3461 | | |
| 33 | Axle Load | Loaded , Front / Rear | | kg | 4235 / 553 | 4551 / 530 | 4871 / 590 | | |
| 34 | | Unloaded , Front / Rear | | kg | 1698 / 1491 | 1696 / 1585 | 1692 / 1769 | | |
| CHASSIS | | | | | | | | | |
| 35 | Tires | Number of Wheels (Front / Rear) | | | 2 / 2 | 2 / 2 | 2 / 2 | | |
| 36 | | Size | Front | | 18x7-8 ¹⁾ | 200x50-10 | 200x50-10 | | |
| 37 | | | Rear | | 16x6-8 ²⁾ | 16x6-8 | 16x6-8 | | |
| 38 | Wheel Base | Distance | | mm | 1495 | 1495 | 1495 | | |
| 39 | Tread Width | Front | | mm | 902 | 912 | 912 | | |
| | | Rear | | mm | 890 | 890 | 890 | | |
| 40 | Ground clearance | Loaded | at lowest | | mm | 86 | 86 | 86 | |
| 41 | | | at center of wheel base | | mm | 100 | 100 | 100 | |
| 42 | Brakes | Service | | | Foot-Electric | Foot-Electric | Foot-Electric | | |
| 43 | | Parking | | | Auto-Electric | Auto-Electric | Auto-Electric | | |
| POWER TRAIN | | | | | | | | | |
| 45 | Battery | Type | | | Lead-acid | Lead-acid | Lead-acid | | |
| | | Voltage | | V | 48 | 48 | 48 | | |
| | | Capacity (5 Hours Rating) | Normal | BS type | AH | 585 | 585 | 585 | |
| | | | | DIN type | AH | 575 | 575 | 575 | |
| | | | Max. | BS type | AH | 690 | 690 | 690 | |
| | | | | DIN type | AH | 625 | 625 | 625 | |
| | | Battery compartment sizes* (L x W x H) | | Normal | mm | 638 x 992 x 698 | 638 x 992 x 698 | 638 x 992 x 698 | |
| | | | | BS type | mm | 638 (608) ³⁾ x 992 x 698 | 638 (608) ³⁾ x 992 x 698 | 638 (608) ³⁾ x 992 x 698 | |
| DIN type | mm | | | 638 x 992 (842) ⁴⁾ x 698 | 638 x 992 (842) ⁴⁾ x 698 | 638 x 992 (842) ⁴⁾ x 698 | | | |
| Min. Weight | | kg | 1050 | 1050 | 1050 | | | | |
| 47 | Electric Motors | Drive motor rating at S2 60 minute | | kW | 6.0 x 2 | 6.0 x 2 | 6.0 x 2 | | |
| 48 | | Lifting motor rating at S3 15% | | kW | 14 | 14 | 14 | | |
| 54 | Control Type | Drive and Hydraulic | | Type | MOSFET Inverter | MOSFET Inverter | MOSFET Inverter | | |
| 55 | Drive Axle | Brake Type | | Type | E-Motor | E-Motor | E-Motor | | |
| 57 | Relief Pressure | System | | kpa | 19900 | 19900 | 21600 | | |
| | | Attachment | | kpa | 14000 | 14000 | 14000 | | |

1) Optional: cushion Tires_18 x 7 - 12.12

2) Optional: cushion Tires_15 x 6 - 11.25

3) If the operator is using a BS Type Battery (608mm length/ 575, 630, 690AH/5h capacity), special accessory (stopper) should be chosen.

4) If the operator is using a DIN Type Battery (842mm width), special accessory (bracket) should be chosen.

*Please refer to the technical bulletin and contact your Doosan representative for more detailed information of battery size. This specification sheet to VDI guideline 2198 only gives the technical figures for the standard truck. Different tires, other masts, additional equipment etc. could give different figures.

DIMENSIONAL DRAWING

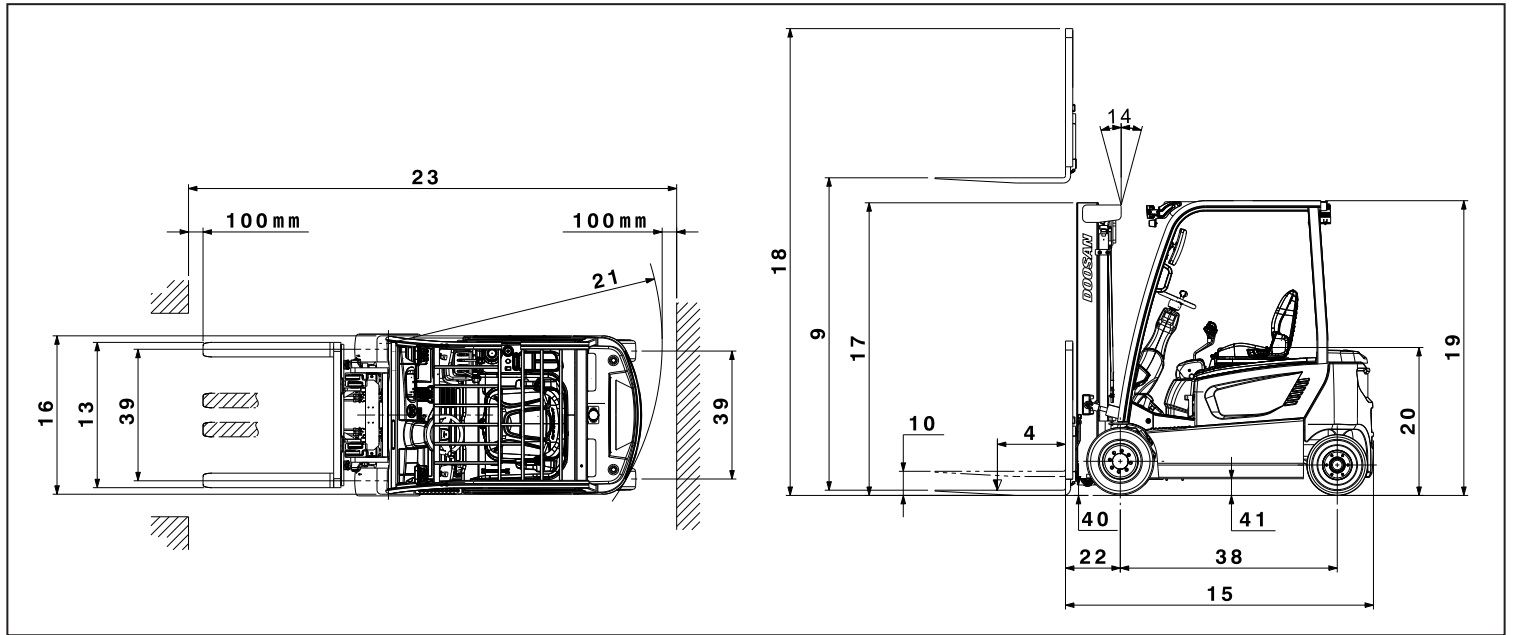

MAST SPECIFICATIONS and RATED CAPACITIES

B16X-7 PLUS

| Mast Type | Maximum Fork Height | Maximum Lowered Height | Extended Height | | Free Lift | | Solid Soft Tire | | Cushion Tire | |
|-----------|---------------------|------------------------|------------------|-------------------|------------------|-------------------|-----------------|---------------|--------------|---------------|
| | | | w/ Load Backrest | w/o Load Backrest | w/ Load Backrest | w/o Load Backrest | Tilt Angle | Load Capacity | Tilt Angle | Load Capacity |
| | | | mm | mm | mm | mm | FWD/BWD | LC 500mm | FWD/BWD | LC 500mm |
| STD | 3000 | 2000 | 4045 | 3600 | 130 | 130 | 5/7 | 1600 | 5/7 | 1500 |
| | 3300 | 2150 | 4345 | 3900 | 130 | 130 | 5/7 | 1600 | 5/7 | 1500 |
| | 3500 | 2250 | 4545 | 4100 | 130 | 130 | 5/7 | 1600 | 5/7 | 1500 |
| | 3700 | 2350 | 4745 | 4300 | 130 | 130 | 5/7 | 1600 | 5/7 | 1500 |
| | 4000 | 2550 | 5045 | 4600 | 130 | 130 | 5/7 | 1600 | 5/7 | 1500 |
| FF | 2700 | 1850 | 3745 | 3325 | 845 | 1265 | 5/5 | 1600 | 5/5 | 1500 |
| | 3000 | 2000 | 4045 | 3625 | 995 | 1415 | 5/5 | 1600 | 5/5 | 1500 |
| | 3300 | 2150 | 4345 | 3925 | 1145 | 1565 | 5/5 | 1600 | 5/5 | 1500 |
| FFT | 4000 | 1880 | 5050 | 4630 | 875 | 1295 | 5/5 | 1600 | 5/5 | 1475 |
| | 4500 | 2045 | 5545 | 5125 | 1040 | 1460 | 5/5 | 1550 | 5/5 | 1425 |
| | 4750 | 2130 | 5795 | 5375 | 1125 | 1545 | 5/5 | 1500 | 5/5 | 1375 |
| | 5000 | 2245 | 6045 | 5625 | 1240 | 1660 | 5/5 | 1450 | 5/5 | 1350 |
| | 5500 | 2480 | 6550 | 6130 | 1475 | 1895 | 5/5 | 1350 | 5/5 | 1275 |
| 6000 | 2645 | 7045 | 6625 | 1640 | 2060 | 5/5 | 1250 | 5/5 | 1225 | |

B18X-7 PLUS

| Mast Type | Maximum Fork Height | Maximum Lowered Height | Extended Height | | Free Lift | | Solid Soft Tire | | Cushion Tire | |
|-----------|---------------------|------------------------|------------------|-------------------|------------------|-------------------|-----------------|---------------|--------------|---------------|
| | | | w/ Load Backrest | w/o Load Backrest | w/ Load Backrest | w/o Load Backrest | Tilt Angle | Load Capacity | Tilt Angle | Load Capacity |
| | | | mm | mm | mm | mm | FWD/BWD | LC 500mm | FWD/BWD | LC 500mm |
| STD | 3000 | 2000 | 4045 | 3600 | 130 | 130 | 5/7 | 1800 | 5/7 | 1750 |
| | 3300 | 2150 | 4345 | 3900 | 130 | 130 | 5/7 | 1800 | 5/7 | 1750 |
| | 3500 | 2250 | 4545 | 4100 | 130 | 130 | 5/7 | 1800 | 5/7 | 1750 |
| | 3700 | 2350 | 4745 | 4300 | 130 | 130 | 5/7 | 1800 | 5/7 | 1750 |
| | 4000 | 2550 | 5045 | 4600 | 130 | 130 | 5/7 | 1800 | 5/7 | 1750 |
| FF | 2700 | 1850 | 3745 | 3325 | 845 | 1265 | 5/5 | 1800 | 5/5 | 1750 |
| | 3000 | 2000 | 4045 | 3625 | 995 | 1415 | 5/5 | 1800 | 5/5 | 1750 |
| | 3300 | 2150 | 4345 | 3925 | 1145 | 1565 | 5/5 | 1800 | 5/5 | 1750 |
| FFT | 4000 | 1880 | 5050 | 4630 | 875 | 1295 | 5/5 | 1800 | 5/5 | 1700 |
| | 4500 | 2045 | 5545 | 5125 | 1040 | 1460 | 5/5 | 1750 | 5/5 | 1650 |
| | 4750 | 2130 | 5795 | 5375 | 1125 | 1545 | 5/5 | 1600 | 5/5 | 1625 |
| | 5000 | 2245 | 6045 | 5625 | 1240 | 1660 | 5/5 | 1550 | 5/5 | 1575 |
| | 5500 | 2480 | 6550 | 6130 | 1475 | 1895 | 5/5 | 1475 | 5/5 | 1500 |
| 6000 | 2645 | 7045 | 6625 | 1640 | 2060 | 5/5 | 1350 | 5/5 | 1400 | |

Note : These load capacities are based on the standard chassis without side shifter.

Specification values quoted in this specification sheet has been rounded. Performance may vary due to operation conditions.

Products and specifications are subject to improvement and change without prior notices.

B20X-7 PLUS

| Mast Type | Maximum Fork Height | Maximum Lowered Height | Extended Height | | Free Lift | | Solid Soft Tire | | Cushion Tire | |
|-----------|---------------------|------------------------|------------------|-------------------|------------------|-------------------|-----------------|---------------|--------------|---------------|
| | | | w/ Load Backrest | w/o Load Backrest | w/ Load Backrest | w/o Load Backrest | Tilt Angle | Load Capacity | Tilt Angle | Load Capacity |
| | | | mm | mm | mm | mm | FWD/BWD | LC 500mm | FWD/BWD | LC 500mm |
| STD | 3000 | 2000 | 4050 | 3605 | 135 | 135 | 5/7 | 2000 | 5/7 | 2000 |
| | 3300 | 2150 | 4350 | 3905 | 135 | 135 | 5/7 | 2000 | 5/7 | 2000 |
| | 3500 | 2250 | 4550 | 4105 | 135 | 135 | 5/7 | 2000 | 5/7 | 2000 |
| | 3700 | 2350 | 4750 | 4305 | 135 | 135 | 5/7 | 2000 | 5/7 | 2000 |
| | 4000 | 2550 | 5050 | 4605 | 135 | 135 | 5/7 | 2000 | 5/7 | 2000 |
| | 4500 | 2800 | 5550 | 5105 | 135 | 135 | 5/7 | 1900 | 5/7 | 2000 |
| FF | 2700 | 1850 | 3750 | 3330 | 845 | 1265 | 5/5 | 2000 | 5/5 | 2000 |
| | 3000 | 2000 | 4050 | 3630 | 995 | 1415 | 5/5 | 2000 | 5/5 | 2000 |
| | 3300 | 2150 | 4350 | 3930 | 1145 | 1565 | 5/5 | 2000 | 5/5 | 2000 |
| FFT | 4000 | 1880 | 5055 | 4635 | 875 | 1295 | 5/5 | 1900 | 5/5 | 2000 |
| | 4500 | 2045 | 5550 | 5130 | 1040 | 1460 | 5/5 | 1900 | 5/5 | 1975 |
| | 4750 | 2130 | 5800 | 5380 | 1125 | 1545 | 5/5 | 1800 | 5/5 | 1925 |
| | 5000 | 2245 | 6050 | 5630 | 1240 | 1660 | 5/5 | 1725 | 5/5 | 1900 |
| | 5500 | 2480 | 6555 | 6135 | 1475 | 1895 | 5/5 | 1650 | 5/5 | 1800 |
| | 6000 | 2645 | 7050 | 6630 | 1640 | 2060 | 5/5 | 1500 | 5/5 | 1500 |

Note : These load capacities are based on the standard chassis without side shifter.



Doosan Industrial Vehicle UK
 12 Kilvey Road, Brackmills Ind
 Estate Northampton, NN4 7BQ
 Tel: 01604 825600
 Website: www.doosanflt.com

2021 JUNE

AUTHORIZED DEALER

MAST SPECIFICATIONS and RATED CAPACITIES

B20NS, B25NS

| Model | Mast Type | Max. Fork Height | Mast Lowered Height | Extended Height | | Free lift | | Pneumatic Tire | | | Solid Soft Tire | | |
|----------------|-----------|------------------|---------------------|------------------|-------------------|------------------|-------------------|----------------|-----|---------------|-----------------|-----|---------------|
| | | | | w/ Load Backrest | w/o Load Backrest | w/ Load Backrest | w/o Load Backrest | Tilt Angle | | Load Capacity | Tilt Angle | | Load Capacity |
| | | | | mm | mm | mm | mm | FWD | BWD | LC 500mm | FWD | BWD | LC 500mm |
| B20NS B25NS | STD | 3,000 | 2,045 | 4,247 | 3,790 | 150 | 150 | 6 | 10 | 2,000 | 6 | 10 | 2,000 |
| | | 3,300 | 2,195 | 4,547 | 4,090 | 150 | 150 | 6 | 10 | 2,000 | 6 | 10 | 2,000 |
| | | 3,500 | 2,295 | 4,747 | 4,290 | 150 | 150 | 6 | 10 | 2,000 | 6 | 10 | 2,000 |
| | | 4,000 | 2,595 | 5,347 | 4,890 | 150 | 150 | 6 | 6 | 2,000 | 6 | 6 | 2,000 |
| | | 4,500 | 2,845 | 5,847 | 5,390 | 150 | 150 | 6 | 6 | 1,900 | 6 | 6 | 1,950 |
| | | 5,000 | 3,095 | 6,347 | 5,890 | 150 | 150 | 6 | 6 | 1,700 | 6 | 6 | 1,800 |
| | FF | 2,930 | 2,015 | 4,194 | 3,737 | 810 | 1,345 | 6 | 10 | 2,000 | 6 | 10 | 2,000 |
| | | 3,210 | 2,155 | 4,474 | 4,017 | 950 | 1,485 | 6 | 10 | 2,000 | 6 | 10 | 2,000 |
| | | 3,580 | 2,205 | 4,849 | 4,392 | 1,000 | 1,535 | 6 | 10 | 1,900 | 6 | 10 | 1,920 |
| | FFT | 3,880 | 1,880 | 5,149 | 4,692 | 675 | 1,210 | 6 | 6 | 1,800 | 6 | 6 | 1,850 |
| | | 4,270 | 2,005 | 5,554 | 5,097 | 800 | 1,335 | 6 | 6 | 1,780 | 6 | 6 | 1,790 |
| | | 4,710 | 2,145 | 5,974 | 5,517 | 940 | 1,475 | 6 | 6 | 1,720 | 6 | 6 | 1,730 |
| | | 5,540 | 2,495 | 6,799 | 6,342 | 1,290 | 1,825 | 6 | 6 | 1,510 | 6 | 6 | 1,550 |
| | | 6,010 | 2,645 | 7,249 | 6,792 | 1,440 | 1,975 | 6 | 6 | 1,100 | 6 | 6 | 1,450 |

B30NS, B35NS

| Model | Mast Type | Max. Fork Height | Mast Lowered Height | Extended Height | | Free lift | | Pneumatic Tire | | | Solid Soft Tire | | |
|----------------|-----------|------------------|---------------------|------------------|-------------------|------------------|-------------------|----------------|-----|---------------|-----------------|-----|---------------|
| | | | | w/ Load Backrest | w/o Load Backrest | w/ Load Backrest | w/o Load Backrest | Tilt Angle | | Load Capacity | Tilt Angle | | Load Capacity |
| | | | | mm | mm | mm | mm | FWD | BWD | LC 500mm | FWD | BWD | LC 500mm |
| B30NS B35NS | STD | 3,000 | 2,045 | 4,247 | 3,790 | 150 | 150 | 6 | 10 | 3,000 | 6 | 10 | 3,000 |
| | | 3,300 | 2,195 | 4,547 | 4,090 | 150 | 150 | 6 | 10 | 3,000 | 6 | 10 | 3,000 |
| | | 3,500 | 2,295 | 4,747 | 4,290 | 150 | 150 | 6 | 10 | 3,000 | 6 | 10 | 3,000 |
| | | 4,000 | 2,595 | 5,347 | 4,890 | 150 | 150 | 6 | 6 | 2,900 | 6 | 6 | 2,950 |
| | | 4,500 | 2,845 | 5,847 | 5,390 | 150 | 150 | 6 | 4 | 2,750 | 6 | 4 | 2,800 |
| | | 5,000 | 3,095 | 6,347 | 5,890 | 150 | 150 | 6 | 4 | 2,300 | 6 | 4 | 2,500 |
| | FFL | 2,930 | 2,015 | 4,194 | 3,737 | 810 | 1,345 | 6 | 10 | 3,000 | 6 | 10 | 3,000 |
| | | 3,210 | 2,155 | 4,474 | 4,017 | 950 | 1,485 | 6 | 10 | 3,000 | 6 | 10 | 3,000 |
| | | 3,580 | 2,205 | 4,849 | 4,392 | 1,000 | 1,535 | 6 | 10 | 3,000 | 6 | 10 | 3,000 |
| | FFT | 3,880 | 1,880 | 5,149 | 4,692 | 675 | 1,210 | 6 | 6 | 2,800 | 6 | 6 | 2,850 |
| | | 4,270 | 2,005 | 5,554 | 5,097 | 800 | 1,335 | 6 | 6 | 2,700 | 6 | 6 | 2,750 |
| | | 4,710 | 2,145 | 5,974 | 5,517 | 940 | 1,475 | 6 | 4 | 2,600 | 6 | 4 | 2,650 |
| | | 5,540 | 2,495 | 6,799 | 6,342 | 1,290 | 1,825 | 6 | 4 | 2,100 | 6 | 4 | 2,400 |
| | | 6,010 | 2,645 | 7,249 | 6,792 | 1,440 | 1,975 | 6 | 4 | 1,500 | 6 | 4 | 2,200 |

Note : Mast Specifications & Rated capacities are based on standard chassis without side shifter. Products and specifications are subject to improvement and change without prior notices.

B25X7-200831ENV1 (August 2020)



Doosan Industrial Vehicle UK
12 Kilvey Road
Northampton
NN4 7BQ
Tel.: 01604 825 600
Website: www.doosanft.com

Authorized Dealer

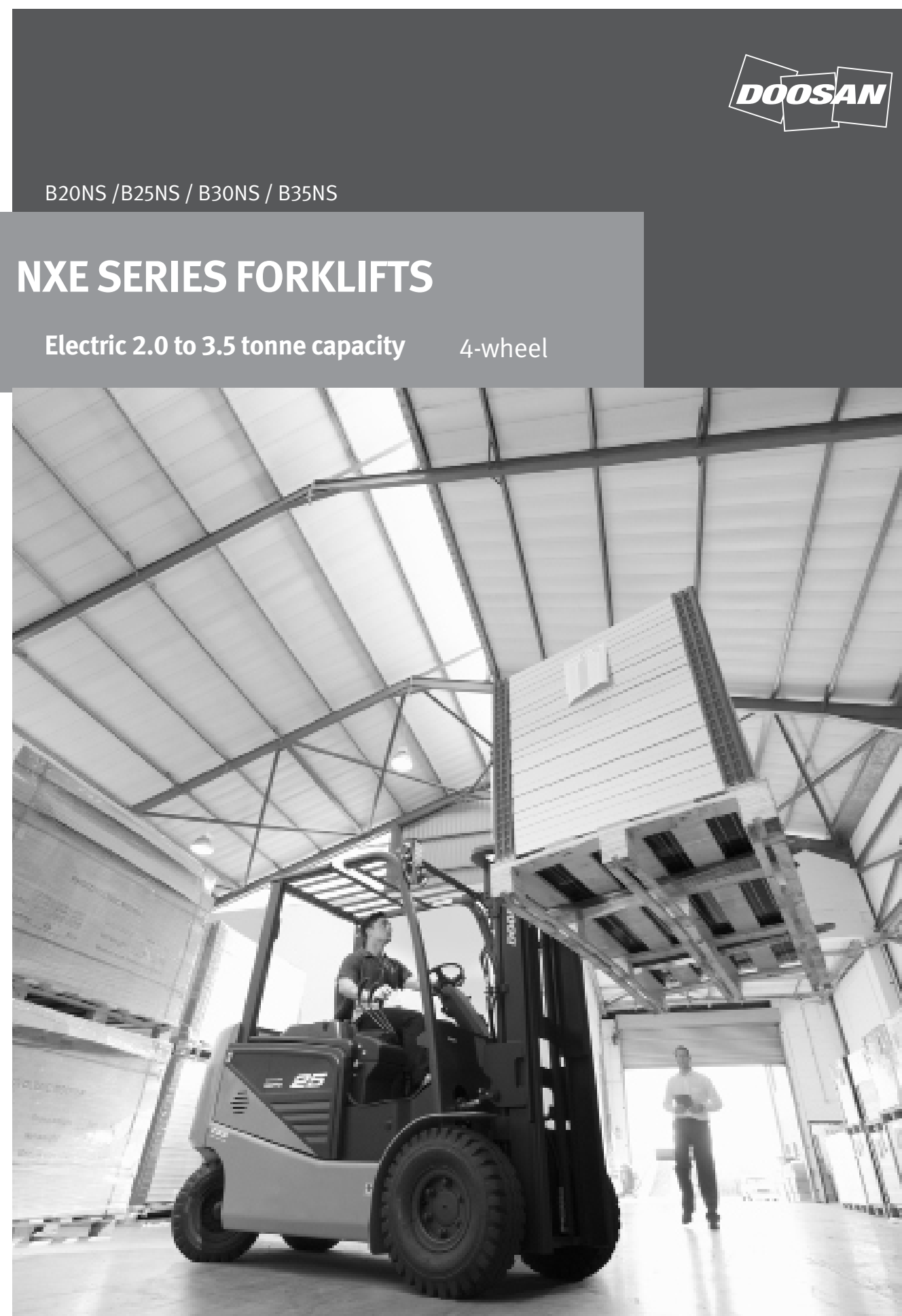

B20NS / B25NS / B30NS / B35NS

NXE SERIES FORKLIFTS

Electric 2.0 to 3.5 tonne capacity 4-wheel

Technical Data according to VDI 2198

| Characteristics | | | DOOSAN | DOOSAN | DOOSAN | |
|-----------------|---|--|--|-------------------|---------------|---------------|
| | | | B20NS | B25NS | B30NS | |
| 1.1 | Manufacturer | | DOOSAN | DOOSAN | DOOSAN | |
| 1.2 | Manufacturer's type designation | | B20NS | B25NS | B30NS | |
| 1.3 | Drive | | Electric | Electric | Electric | |
| 1.4 | Operator typer | | Seated | Seated | Seated | |
| 1.5 | Load capacity/rated load kg(lb) | kg Q | 2,000 | 2,500 | 3,000 | |
| 1.6 | Load centre distance | mm c | 500 | 500 | 500 | |
| 1.8 | Load distance, centre of drive axle to fork | mm x | 457 | 457 | 457 | |
| 1.9 | Wheelbase | mm y | 1,560 | 1,560 | 1,710 | |
| Weight | 2.1 | Service weight (with min. weight of battery) | kg | 3,810 | 4,150 | 4,360 |
| | 2.2 | Axle loading, loaded front/rear | kg | 5,190/620 | 5,979/671 | 6,500/860 |
| | 2.3 | Axle loading, unloaded front/rear | kg | 1,658/2,152 | 1,830/2,320 | 1,882/2,478 |
| Tyres | 3.1 | Tires: pneumatic (P), superelastic (SE), cushion (C) SE | | P / SE | P / SE | P / SE |
| | 3.2 | Tire size, front | | 23X9-10 | 23X9-10 | 23X10-12 |
| | 3.3 | Tire size, rear | | 18X7-8 | 18X7-8 | 18X7-8 |
| | 3.5 | Wheels, number front/rear (x=driven wheels) | | 2X/2 | 2X/2 | 2X/2 |
| | 3.6 | Tread width, front | mm b10 | 1,019 | 1,019 | 1,014 |
| | 3.7 | Tread width, rear | mm b11 | 995 | 995 | 995 |
| | Dimensions | 4.1 | Tilt of mast/fork carriage forward (α)/backward(β) | deg α / β | 6 / 10 | 6 / 10 |
| 4.2 | | Height, mast lowered | mm h1 | 2,045 | 2,045 | 2,045 |
| 4.3 | | Free lift | mm h2 | 150 | 150 | 150 |
| 4.4 | | Lift (with STD 2-stage mast) | mm h3 | 3,000 | 3,000 | 3,000 |
| 4.5 | | Height, mast extended | mm h4 | 4,247 | 4,247 | 4,247 |
| 4.7 | | Height to top of overhead guard | mm h6 | 2,180 | 2,180 | 2,180 |
| 4.8 | | Seat height/stand height | mm h7 | 1,183 | 1,183 | 1,183 |
| 4.12 | | Towing coupling height | mm h10 | 360 | 360 | 360 |
| 4.19 | | Overall length | mm l1 | 3,360 | 3,400 | 3,570 |
| 4.20 | | Length to face of forks | mm l2 | 2,310 | 2,350 | 2,520 |
| 4.21 | | Overall width | mm b1 | 1,244 | 1,244 | 1,244 |
| 4.22 | | Fork dimensions | mm | 45/100/1,050 | 45/100/1,050 | 45/122/1,050 |
| 4.23 | | Fork carriage ISO 2328. Class/type A, B | | II | II | III |
| 4.24 | | Fork carriage width | mm b3 | 1,102 | 1,102 | 1,116 |
| 4.24a | | Fork Spacing (min/max) | mm | 250/1,032 | 250/1,032 | 272/1,104 |
| 4.31 | | Ground clearance, with load, below mast | mm m1 | 140 | 140 | 140 |
| 4.32 | | Ground clearance, centre of wheelbase | mm m2 | 125 | 125 | 125 |
| 4.34.1 | | Aisle width for pallets 1,000 x 1,200 crossways | mm Ast | 3,697 | 3,717 | 3,957 |
| 4.34.2 | | Aisle width for pallets 800 x 1,200 lengthways | mm Ast | 3,897 | 3,917 | 4,157 |
| 4.35 | Turning radius | mm Wa | 2,040 | 2,060 | 2,300 | |
| 4.36 | Internal turning radius | mm b13 | 650 | 650 | 677 | |
| Performance | 5.1 | Travel speed, loaded / unloaded | km/h | 14/15 | 14/15 | 14/15 |
| | 5.2 | Lift speed, loaded / unloaded | mm/s | 320/450 | 300/450 | 280/400 |
| | 5.3 | Lowering speed, loaded / unloaded | mm/s | 500/460 | 500/460 | 380/365 |
| | 5.6 | Maximum drawbar pull, loaded / unloaded, 5 minute rating | N | 10,910/10,500 | 1,0910/10,700 | 14,460/13,560 |
| | 5.8 | Maximum gradeability, loaded / unloaded, 5 minute rating | % | 15 / 27 | 15 / 25 | 15 / 27 |
| | 5.10 | Service brake | | Electric | Electric | Electric |
| | | Parking brake | | Mech/EPB | Mech/EPB | Mech/EPB |
| Electric engine | 6.1 | Drive motor rating S2 60 minute | kW | 11/9 | 11/9 | 16.6/12 |
| | 6.2 | Lifting motor rating at S3 15% | kW | 12/14 | 12/14 | 13.5/16 |
| | | Battery type | | Lead-acid | Lead-acid | Lead-acid |
| | 6.3 | Battery Compartment L/W/H | mm | 570x1,028x755 | 570x1,028x755 | 710x1,028x745 |
| | 6.4 | Battery voltage/nominal capacity K | V/Ah | 48/600 | 48/600 | 80/420 |
| | 6.5 | Battery weight | kg | 1,000 | 1,000 | 1,582 |
| 8.1 | Type of drive control unit | | AC | AC | AC | |
| Additional data | 10.1 | Working press for attachments | bar | System 200 | 200 | 200 |
| | | | | Attachment 200 | 200 | 200 |
| | 10.7 | Sound level at the driver's ear according to EN 12 053 | dB (A) | 68 | 68 | 68 |

DIMENSIONAL DRAWING

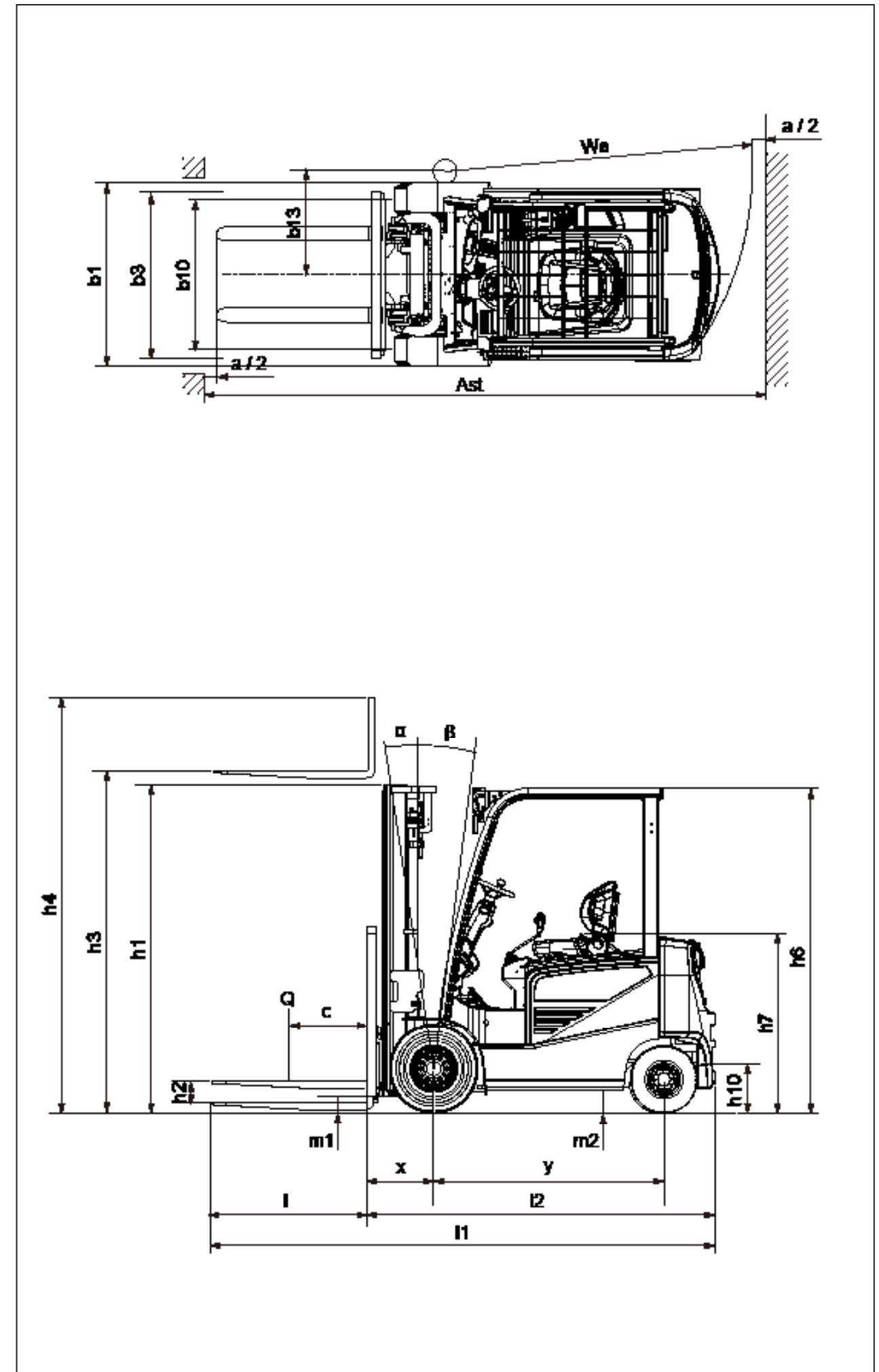

Note : Specification values quoted in this specification sheet have been rounded. Performance may vary due to operation conditions. Products and specifications are subject to improvement and change without prior notices.



www.doosan-iv.com

7 PLUS Series Forklifts

Electric 2.5 to 3.5 tonne capacity
B25/30/35X-7 PLUS



Lifting Your Dreams

GENERAL SPECIFICATION

| | | | | | | | | | |
|-----------------|---|-----------------------------------|-------------------------------------|------------------------|---------------|------------------|-------------------|--------------|-----|
| CHARACTERISTICS | 1 | Manufacturer | | | Doosan | Doosan | Doosan | | |
| | 2 | Model | | | B25X-7 PLUS | B30X-7 PLUS | B35X-7 PLUS | | |
| | 3 | Capacity | at rated load center | kg | 2,500 | 3,000 | 3,500 | | |
| | 4 | Load center | distance | mm | 500 | 500 | 500 | | |
| | 5 | Power type | | | AC electric | AC electric | AC electric | | |
| | 6 | Operator type | | | driver seated | driver seated | driver seated | | |
| | 7 | Tire type | C=cushion, P=pneumatic, E=Solid | | | P, E | P, E | P, E | |
| | 8 | Wheels (x=driven) | number, front/rear | | | x 2/2 | x 2/2 | x 2/2 | |
| DIMENSIONS | 9 | Maximum fork height | with STD 2-stage mast | | mm | 3,230 | 3,230 | 3,000 | |
| | 10 | Free lift | | | mm | 147 | 152 | 152 | |
| | 11 | Fork carriage | ISO class | | | II | III | III | |
| | 12 | Forks | thickness x width x length | | mm | 40x100x1,050 | 45x125x1,050 | 45x125x1,050 | |
| | 13 | | fork spacing (min x max) | | mm | 272 x 1,035 | 286 x 1,044 | 286 x 1,044 | |
| | 14 | Tilt of mast | forward / backward | | deg | 6/9 | 6/9 | 6/9 | |
| | 15 | Overall dimensions | length to forkface | | mm | 2,329 | 2,480 | 2,564 | |
| | 16 | | overall width | | mm | 1,245 | 1,245 | 1,245 | |
| | 17 | | mast lowered height | | mm | 2,160 | 2,160 | 2,160 | |
| | 18 | | mast extended height | | mm | 3,990 | 3,990 | 3,760 | |
| | 19 | | overhead guard height (Cabin) | | mm | 2,185 | 2,210 | 2,210 | |
| | 20 | | seat height | | mm | 1,070 | 1,070 | 1,070 | |
| | 21 | Outer turning radius | | | mm | 1,950 | 2,095 | 2,155 | |
| | | Inner turning radius | | | mm | 348 | 340 | 340 | |
| 22 | Load moment constant | center of drive axle to fork face | | mm | 448 | 454 | 454 | | |
| 23 | Right Angle Stacking Aisle Width (with pallets & clearance) | | pallet 1,000x1,200 crossways | mm | 3,620 | 3,772 | 3,832 | | |
| | | | pallet 800x1,200 lengthways | mm | 3,799 | 3,950 | 4,010 | | |
| PERFORMANCE | 24 | Speed | travel | loaded/unloaded | km/h | 16/18 | 16/18 | 16/18 | |
| | 25 | | lift | loaded/unloaded | mm/s | 480/600 | 420/600 | 380/600 | |
| | 26 | | lowering | loaded/unloaded | mm/s | 490/460 | 490/460 | 500/460 | |
| | 28 | Max. drawbar pull | at 1.6 km/h, loaded/unloaded | | kg.f | 1,768/1,675 | 1,768/1,675 | 1,768/1,675 | |
| 30 | Gradeability | at 1.6 km/h, loaded/unloaded | | % | 25/38 | 22/34 | 20/31 | | |
| WEIGHT | 32 | Total weight | with min. weight of battery | | kg | 4,623 | 5,068 | 5,486 | |
| | 33 | Axle load | loaded, front/rear | | kg | 6,275/848 | 7,197/870 | 7,940/1,046 | |
| | 34 | | unloaded, front/rear | | kg | 2,284/2,339 | 2,547/2,521 | 2,532/2,954 | |
| CHASSIS | 35 | number of front/rear | | | 2/2 | 2/2 | 2/2 | | |
| | 36 | Tires | size | front | | 23x10-12 | 23x10-12 | 23x10-12 | |
| | 37 | | | rear | | 18x7-8 | 18x7-8 | 18x7-8 | |
| | 38 | Wheel base | distance | | mm | 1,589 | 1,734 | 1,750 | |
| | 39 | Tread width | front | | mm | 998 | 998 | 998 | |
| | | | rear | | mm | 998 | 998 | 998 | |
| | 40 | Ground clearance | loaded | at the lowest point | | mm | 130 | 130 | 130 |
| | 41 | | | at center of wheelbase | | mm | 140 | 140 | 140 |
| 42 | Brakes | service brake | | | hydraulic | hydraulic | hydraulic | | |
| 43 | | parking brake | | | auto-electric | auto-electric | auto-electric | | |
| POWER TRAIN | 45 | Battery | type | | | DIN 43536 A | DIN 43536 A | DIN 43536 A | |
| | | | voltage | | V | 80 | 80 | 80 | |
| | | | capacity (5 hours rating) - normal | | AH | 500 | 600 | 600 | |
| | | | capacity (5 hours rating) - max. | | AH | 620 | 775 | 775 | |
| | 46 | Battery compartment* | at chassis sizes (W x L x H) | | mm | 1040 x 720 x 805 | 1,040 x 865 x 805 | | |
| | 47 | Electric motors | drive motor rating at S2 60 minutes | | kW | 10.0 x 2 | 10.0 x 2 | 10.0 x 2 | |
| | 48 | | lifting motor rating at S3 15% | | kW | 21 | 21 | 21 | |
| | 54 | Control type | drive and hydraulic | | type | MOSFET inverter | | | |
| 55 | Drive axle | brake type | | type | E-Motor | | | | |
| 57 | Relief pressure | system | | bar | 193 | 207 | 235 | | |
| | | attachment | | bar | 155 | 155 | 155 | | |

*Please refer to the technical bulletin and contact your Doosan representative for more detailed information of battery size.

This specification sheet to VDI guideline 2198 only gives the technical figures for the standard truck. Different tires, other masts, additional equipment etc. could give different figures.

DIMENSIONAL DRAWING

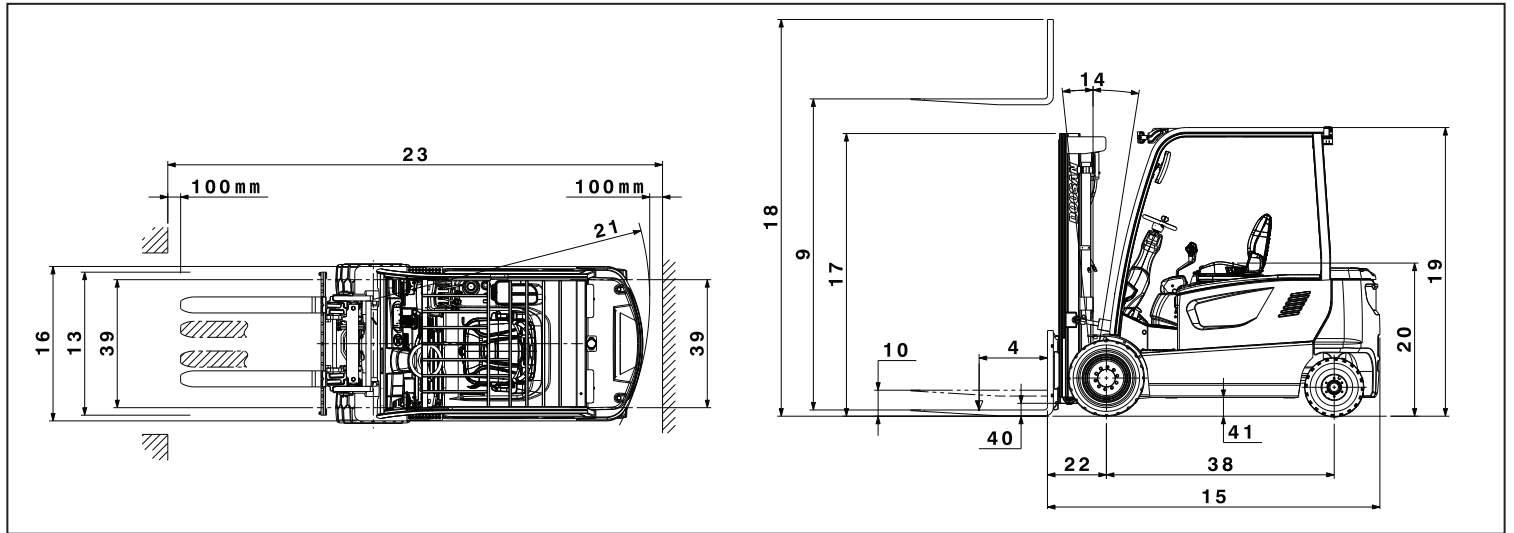

MAST SPECIFICATIONS and RATED CAPACITIES

B25X-7 PLUS

| Mast type | Maximum Fork Height | Maximum Lowered Height | Fully Extended Height | Free Lift | Rated Load Capacities | | | | | |
|-----------|---------------------|------------------------|-----------------------|--------------------|-----------------------|-----|--------------|-----|-----------------|--------------|
| | | | with Load Backrest | With Load Backrest | Tilt Angle | | | | Load Capacities | |
| | | | | | Single Pneu. | | Single Solid | | Single Pneu. | Single Solid |
| | | | | | FWD | BWD | FWD | BWD | LC500mm | LC500mm |
| mm | mm | mm | mm | deg | deg | deg | deg | kg | kg | |
| STD | 2,950 | 2,020 | 4,200 | 147 | 6 | 9 | 6 | 9 | 2,500 | 2,500 |
| | 3,230 | 2,160 | 4,480 | 147 | 6 | 9 | 6 | 9 | 2,500 | 2,500 |
| | 3,500 | 2,410 | 4,755 | 147 | 6 | 9 | 6 | 9 | 2,500 | 2,500 |
| | 3,800 | 2,560 | 5,055 | 147 | 6 | 9 | 6 | 9 | 2,500 | 2,500 |
| | 3,950 | 2,635 | 5,205 | 147 | 6 | 9 | 6 | 9 | 2,500 | 2,500 |
| | 4,350 | 2,835 | 5,605 | 147 | 6 | 9 | 6 | 9 | 2,500 | 2,500 |
| | 4,960 | 3,135 | 6,205 | 147 | 6 | 9 | 6 | 9 | 2,425 | 2,450 |
| FF | 2,950 | 2,020 | 4,200 | 815 | 6 | 9 | 6 | 9 | 2,500 | 2,500 |
| | 3,230 | 2,160 | 4,480 | 955 | 6 | 9 | 6 | 9 | 2,500 | 2,500 |
| | 3,600 | 2,410 | 4,855 | 1,205 | 6 | 9 | 6 | 9 | 2,500 | 2,500 |
| FFT | 3,900 | 1,885 | 5,155 | 680 | 6 | 9 | 6 | 9 | 2,500 | 2,500 |
| | 4,290 | 2,020 | 5,560 | 815 | 6 | 9 | 6 | 9 | 2,500 | 2,500 |
| | 4,730 | 2,160 | 5,980 | 955 | 6 | 9 | 6 | 9 | 2,475 | 2,500 |
| | 4,805 | 2,165 | 6,055 | 980 | 6 | 9 | 6 | 9 | 2,450 | 2,475 |
| | 5,560 | 2,510 | 6,805 | 1,305 | 6 | 5 | 6 | 9 | 2,275 | 2,325 |
| | 6,010 | 2,660 | 7,255 | 1,455 | 6 | 5 | 6 | 9 | 1,700 | 2,250 |

B30X-7 PLUS

| Mast type | Maximum Fork Height | Maximum Lowered Height | Fully Extended Height | Free Lift | Rated Load Capacities | | | | | |
|-----------|---------------------|------------------------|-----------------------|--------------------|-----------------------|-----|--------------|-----|-----------------|--------------|
| | | | with Load Backrest | with Load Backrest | Tilt Angle | | | | Load Capacities | |
| | | | | | Single Pneu. | | Single Solid | | Single Pneu. | Single Solid |
| | | | | | FWD | BWD | FWD | BWD | LC500mm | LC500mm |
| mm | mm | mm | mm | deg | deg | deg | deg | kg | kg | |
| STD | 2,950 | 2,020 | 4,200 | 152 | 6 | 9 | 6 | 9 | 3,000 | 3,000 |
| | 3,230 | 2,160 | 4,480 | 152 | 6 | 9 | 6 | 9 | 3,000 | 3,000 |
| | 3,500 | 2,410 | 4,755 | 152 | 6 | 9 | 6 | 9 | 3,000 | 3,000 |
| | 3,800 | 2,560 | 5,055 | 152 | 6 | 9 | 6 | 9 | 3,000 | 3,000 |
| | 3,950 | 2,635 | 5,205 | 152 | 6 | 9 | 6 | 9 | 3,000 | 3,000 |
| | 4,350 | 2,835 | 5,605 | 152 | 6 | 9 | 6 | 9 | 2,950 | 2,975 |
| | 4,960 | 3,135 | 6,205 | 152 | 6 | 5 | 6 | 9 | 2,800 | 2,825 |
| FF | 2,950 | 2,020 | 4,200 | 820 | 6 | 9 | 6 | 9 | 3,000 | 3,000 |
| | 3,230 | 2,160 | 4,480 | 960 | 6 | 9 | 6 | 9 | 3,000 | 3,000 |
| | 3,600 | 2,410 | 4,855 | 1,210 | 6 | 9 | 6 | 9 | 3,000 | 3,000 |
| FFT | 3,900 | 1,885 | 5,155 | 685 | 6 | 9 | 6 | 9 | 2,900 | 2,900 |
| | 4,290 | 2,020 | 5,560 | 820 | 6 | 9 | 6 | 9 | 2,900 | 2,900 |
| | 4,730 | 2,160 | 5,980 | 960 | 6 | 9 | 6 | 9 | 2,850 | 2,875 |
| | 4,805 | 2,165 | 6,055 | 985 | 6 | 9 | 6 | 9 | 2,850 | 2,875 |
| | 5,560 | 2,510 | 6,805 | 1,310 | 6 | 5 | 6 | 9 | 2,300 | 2,700 |
| | 6,010 | 2,660 | 7,255 | 1,460 | 6 | 5 | 6 | 5 | 1,775 | 2,600 |

B35X-7 PLUS

| Mast type | Maximum Fork Height | Maximum Lowered Height | Fully Extended Height | Free Lift | Rated Load Capacities | | | | | |
|-----------|---------------------|------------------------|-----------------------|--------------------|-----------------------|-----|--------------|-----|-----------------|--------------|
| | | | with Load Backrest | with Load Backrest | Tilt Angle | | | | Load Capacities | |
| | | | | | Single Pneu. | | Single Solid | | Single Pneu | Single Solid |
| | | | | | FWD | BWD | FWD | BWD | LC500mm | LC500mm |
| mm | mm | mm | mm | deg | deg | deg | deg | kg | kg | |
| STD | 2,720 | 2,020 | 3,970 | 152 | 6 | 9 | 6 | 9 | 3,500 | 3,500 |
| | 3,000 | 2,160 | 4,250 | 152 | 6 | 9 | 6 | 9 | 3,500 | 3,500 |
| | 3,495 | 2,410 | 4,750 | 152 | 6 | 9 | 6 | 9 | 3,500 | 3,500 |
| | 3,655 | 2,560 | 4,905 | 152 | 6 | 9 | 6 | 9 | 3,500 | 3,500 |
| | 3,805 | 2,635 | 5,055 | 152 | 6 | 9 | 6 | 9 | 3,500 | 3,500 |
| | 4,805 | 3,135 | 6,055 | 152 | 6 | 5 | 6 | 9 | 3,125 | 3,425 |
| FF | 2,720 | 2,020 | 3,970 | 820 | 6 | 5 | 6 | 9 | 3,500 | 3,500 |
| | 3,000 | 2,160 | 4,250 | 960 | 6 | 5 | 6 | 9 | 3,500 | 3,500 |
| | 3,495 | 2,410 | 4,745 | 1,210 | 6 | 5 | 6 | 9 | 3,500 | 3,500 |
| FFT | 3,555 | 1,885 | 4,805 | 685 | 6 | 9 | 6 | 9 | 3,400 | 3,400 |
| | 3,960 | 2,020 | 5,210 | 820 | 6 | 9 | 6 | 9 | 3,400 | 3,400 |
| | 4,380 | 2,160 | 5,630 | 960 | 6 | 9 | 6 | 9 | 3,300 | 3,400 |
| | 4,820 | 2,330 | 6,070 | 1,130 | 6 | 5 | 6 | 9 | 3,175 | 3,400 |
| | 5,205 | 2,510 | 6,455 | 1,310 | 6 | 5 | 6 | 9 | 2,575 | 3,300 |
| | 5,655 | 2,660 | 6,905 | 1,460 | 6 | 5 | 6 | 5 | 2,000 | 3,200 |

Note: These load capacities are based on the standard chassis without side shifter.

Specification values quoted in this spec sheet have been rounded. Products and specifications are subject to improvement and change without notice. Performance may vary due to operating conditions.

The performance shown represents nominal values obtained under typical operating conditions.

2021 June



Doosan Industrial Vehicle UK
 12 Kilvey Road, Brackmills Ind
 Estate Northampton, NN4 7BQ
 Tel: 01604 825600
 Website: www.doosanflt.com

AUTHORIZED DEALER



| Mast type | Maximum Fork Height | Maximum Lowered Height | Fully Extended Height | Free Lift | Rated Load Capacities | | | | | | | |
|-----------|---------------------|------------------------|-----------------------|-----------|-----------------------|--------------------|--------------|-------|--------------|-------|-----------------|--------------|
| | | | | | B35X-7 | | | | | | | |
| | | | | | with Load Backrest | with Load Backrest | Tilt Angle | | | | Load Capacities | |
| | | | | | | | Single Pneu. | | Single Solid | | Single Pneu | Single Solid |
| | | | | | | | FWD | BWD | FWD | BWD | LC500mm | LC500mm |
| deg | deg | deg | deg | kg | kg | | | | | | | |
| mm | mm | mm | mm | mm | deg | deg | deg | deg | kg | kg | | |
| STD | 2,720 | 2,020 | 3,970 | 152 | 6 | 9 | 6 | 9 | 3,500 | 3,500 | | |
| | 3,000 | 2,160 | 4,250 | 152 | 6 | 9 | 6 | 9 | 3,500 | 3,500 | | |
| | 3,495 | 2,410 | 4,750 | 152 | 6 | 9 | 6 | 9 | 3,500 | 3,500 | | |
| | 3,655 | 2,560 | 4,905 | 152 | 6 | 9 | 6 | 9 | 3,500 | 3,500 | | |
| | 3,805 | 2,635 | 5,055 | 152 | 6 | 9 | 6 | 9 | 3,500 | 3,500 | | |
| 4,805 | 3,135 | 6,055 | 152 | 6 | 5 | 6 | 9 | 3,125 | 3,425 | | | |
| FF | 2,720 | 2,020 | 3,970 | 820 | 6 | 5 | 6 | 9 | 3,500 | 3,500 | | |
| | 3,000 | 2,160 | 4,250 | 960 | 6 | 5 | 6 | 9 | 3,500 | 3,500 | | |
| | 3,495 | 2,410 | 4,745 | 1,210 | 6 | 5 | 6 | 9 | 3,500 | 3,500 | | |
| FFT | 3,555 | 1,885 | 4,805 | 685 | 6 | 9 | 6 | 9 | 3,400 | 3,400 | | |
| | 3,960 | 2,020 | 5,210 | 820 | 6 | 9 | 6 | 9 | 3,400 | 3,400 | | |
| | 4,380 | 2,160 | 5,630 | 960 | 6 | 9 | 6 | 9 | 3,300 | 3,400 | | |
| | 4,820 | 2,330 | 6,070 | 1,130 | 6 | 5 | 6 | 9 | 3,175 | 3,400 | | |
| | 5,205 | 2,510 | 6,455 | 1,310 | 6 | 5 | 6 | 9 | 2,575 | 3,300 | | |
| 5,655 | 2,660 | 6,905 | 1,460 | 6 | 5 | 6 | 5 | 2,000 | 3,200 | | | |

Note: These load capacities are based on the standard chassis without side shifter.
 Specification values quoted in this catalog have been rounded.
 Products and specifications are subject to improvement and change without notice.
 Performance may vary due to operating conditions.
 The performance shown represents nominal values obtained under typical operating conditions.

7-Series Forklifts

Electric 2.2 to 3.5 ton capacity



EUB25X7-160205V1EN



Doosan Industrial Vehicle UK
 12 Kilvey Road
 Brackmills Industrial Estate
 Northampton
 NN4 7BQ
 Tel.: +44 1604 825 600
 Website: www.doosanforklifts.co.uk

AUTHORIZED DEALER

Lifting Your Dreams

MAST SPECIFICATION and RATED CAPACITIES

B40X-7

| Mast Type | Max. Fork Height | | Mast Lowered Height | | Extended Height | | Free Lift | | Rated Load Capacities | | | |
|-----------|------------------|-----|---------------------|-----|------------------|-----|------------------|----|-----------------------|---------|-----------------|------------|
| | mm | in | mm | in | w/ Load Backrest | | w/ Load Backrest | | Tilt Angle | | Load capacities | |
| | | | | | mm | in | mm | in | Fwd deg | Bwd deg | LC 500mm kg | LC 24in lb |
| STD | 3000 | 118 | 2190 | 86 | 4265 | 168 | 160 | 6 | 6 | 9 | 4000 | 8000 |
| | 3300 | 130 | 2340 | 92 | 4565 | 180 | 160 | 6 | 6 | 9 | 4000 | 8000 |
| | 3650 | 144 | 2515 | 99 | 4915 | 194 | 160 | 6 | 6 | 9 | 4000 | 8000 |
| | 4000 | 157 | 2840 | 112 | 5265 | 207 | 160 | 6 | 6 | 9 | 4000 | 8000 |
| | 4250 | 167 | 2965 | 117 | 5515 | 217 | 160 | 6 | 6 | 9 | 4000 | 8000 |
| | 4850 | 191 | 3415 | 134 | 6115 | 241 | 160 | 6 | 6 | 5 | 4000 | 8000 |
| FF | 3000 | 118 | 2170 | 85 | 4240 | 167 | 970 | 38 | 6 | 9 | 4000 | 8000 |
| | 4000 | 157 | 2050 | 81 | 5265 | 207 | 850 | 33 | 6 | 9 | 4000 | 8000 |
| FFT | 4250 | 167 | 2140 | 84 | 5530 | 218 | 940 | 37 | 6 | 9 | 4000 | 8000 |
| | 4700 | 185 | 2290 | 90 | 5980 | 235 | 1090 | 43 | 6 | 9 | 4000 | 8000 |
| | 5150 | 203 | 2440 | 96 | 6430 | 253 | 1240 | 49 | 6 | 5 | 3940 | 8000 |
| | 5600 | 220 | 2590 | 102 | 6880 | 271 | 1390 | 55 | 6 | 5 | 3810 | 7800 |
| | 6050 | 238 | 2740 | 108 | 7330 | 289 | 1540 | 61 | 6 | 3 | 3670 | 7500 |

B45X-7

| Mast Type | Max. Fork Height | | Mast Lowered Height | | Extended Height | | Free Lift | | Rated Load Capacities | | | |
|-----------|------------------|-----|---------------------|-----|------------------|-----|------------------|----|-----------------------|---------|-----------------|------------|
| | mm | in | mm | in | w/ Load Backrest | | w/ Load Backrest | | Tilt Angle | | Load capacities | |
| | | | | | mm | in | mm | in | Fwd deg | Bwd deg | LC 500mm kg | LC 24in lb |
| STD | 3000 | 118 | 2185 | 86 | 4265 | 168 | 160 | 6 | 6 | 9 | 4500 | 9000 |
| | 3300 | 130 | 2335 | 92 | 4565 | 180 | 160 | 6 | 6 | 9 | 4500 | 9000 |
| | 3650 | 144 | 2510 | 99 | 4915 | 194 | 160 | 6 | 6 | 9 | 4500 | 9000 |
| | 4000 | 157 | 2835 | 112 | 5265 | 207 | 160 | 6 | 6 | 9 | 4500 | 9000 |
| | 4250 | 167 | 2960 | 117 | 5515 | 217 | 160 | 6 | 6 | 9 | 4500 | 9000 |
| | 4850 | 191 | 3410 | 134 | 6115 | 241 | 160 | 6 | 6 | 5 | 4500 | 9000 |
| FF | 3000 | 118 | 2165 | 85 | 4240 | 167 | 965 | 38 | 6 | 9 | 4500 | 9000 |
| FFT | 4000 | 157 | 2050 | 81 | 5265 | 207 | 850 | 33 | 6 | 9 | 4500 | 9000 |
| | 4250 | 167 | 2135 | 84 | 5530 | 218 | 935 | 37 | 6 | 9 | 4500 | 9000 |
| | 4700 | 185 | 2285 | 90 | 5980 | 235 | 1085 | 43 | 6 | 9 | 4500 | 9000 |
| | 5150 | 203 | 2435 | 96 | 6430 | 253 | 1235 | 49 | 6 | 5 | 4500 | 9000 |
| | 5600 | 220 | 2585 | 102 | 6880 | 271 | 1385 | 55 | 6 | 5 | 4350 | 8800 |
| | 6050 | 238 | 2735 | 108 | 7330 | 289 | 1535 | 60 | 6 | 3 | 4225 | 8500 |

B50XC-7

| Mast Type | Max. Fork Height | | Mast Lowered Height | | Extended Height | | Free Lift | | Rated Load Capacities | | | |
|-----------|------------------|-----|---------------------|-----|------------------|-----|------------------|----|-----------------------|---------|-----------------|------------|
| | mm | in | mm | in | w/ Load Backrest | | w/ Load Backrest | | Tilt Angle | | Load capacities | |
| | | | | | mm | in | mm | in | Fwd deg | Bwd deg | LC 500mm kg | LC 24in lb |
| STD | 3000 | 118 | 2185 | 86 | 4415 | 174 | 160 | 6 | 6 | 9 | 4990 | 9980 |
| | 3300 | 130 | 2335 | 92 | 4715 | 186 | 160 | 6 | 6 | 9 | 4990 | 9980 |
| | 3650 | 144 | 2510 | 99 | 5065 | 199 | 160 | 6 | 6 | 9 | 4990 | 9980 |
| | 4000 | 157 | 2835 | 112 | 5415 | 213 | 160 | 6 | 6 | 9 | 4990 | 9980 |
| | 4250 | 167 | 2960 | 117 | 5665 | 223 | 160 | 6 | 6 | 9 | 4990 | 9980 |
| | 4850 | 191 | 3410 | 134 | 6265 | 247 | 160 | 6 | 6 | 5 | 4990 | 9980 |
| FF | 3000 | 118 | 2165 | 85 | 4240 | 167 | 965 | 38 | 6 | 9 | 4990 | 9980 |
| FFT | 4000 | 157 | 2050 | 81 | 5265 | 207 | 850 | 33 | 6 | 9 | 4990 | 9980 |
| | 4250 | 167 | 2135 | 84 | 5530 | 218 | 935 | 37 | 6 | 9 | 4990 | 9980 |
| | 4700 | 185 | 2285 | 90 | 5980 | 235 | 1085 | 43 | 6 | 9 | 4990 | 9980 |
| | 5150 | 203 | 2435 | 96 | 6430 | 253 | 1235 | 49 | 6 | 5 | 4810 | 9800 |
| | 5600 | 220 | 2585 | 102 | 6880 | 271 | 1385 | 55 | 6 | 5 | 4660 | 9500 |
| | 6050 | 238 | 2735 | 108 | 7330 | 289 | 1535 | 60 | 6 | 3 | 4480 | 9200 |

B50X-7

| Mast Type | Max. Fork Height | | Mast Lowered Height | | Extended Height | | Free Lift | | Rated Load Capacities | | | |
|-----------|------------------|-----|---------------------|-----|------------------|-----|------------------|----|-----------------------|---------|-----------------|------------|
| | mm | in | mm | in | w/ Load Backrest | | w/ Load Backrest | | Tilt Angle | | Load capacities | |
| | | | | | mm | in | mm | in | Fwd deg | Bwd deg | LC 500mm kg | LC 24in lb |
| STD | 3000 | 118 | 2185 | 86 | 4415 | 174 | 160 | 6 | 6 | 9 | 5000 | 10000 |
| | 3300 | 130 | 2335 | 92 | 4715 | 186 | 160 | 6 | 6 | 9 | 5000 | 10000 |
| | 3650 | 144 | 2510 | 99 | 5065 | 199 | 160 | 6 | 6 | 9 | 5000 | 10000 |
| | 4000 | 157 | 2835 | 112 | 5415 | 213 | 160 | 6 | 6 | 9 | 5000 | 10000 |
| | 4250 | 167 | 2960 | 117 | 5665 | 223 | 160 | 6 | 6 | 9 | 5000 | 10000 |
| | 4850 | 191 | 3410 | 134 | 6265 | 247 | 160 | 6 | 6 | 5 | 5000 | 10000 |
| FF | 3000 | 118 | 2165 | 85 | 4390 | 173 | 815 | 32 | 6 | 9 | 5000 | 10000 |
| FFT | 4000 | 157 | 2050 | 81 | 5415 | 213 | 700 | 28 | 6 | 9 | 5000 | 10000 |
| | 4250 | 167 | 2135 | 84 | 5680 | 224 | 785 | 31 | 6 | 9 | 5000 | 10000 |
| | 4700 | 185 | 2285 | 90 | 6130 | 241 | 935 | 37 | 6 | 9 | 5000 | 10000 |
| | 5150 | 203 | 2435 | 96 | 6580 | 259 | 1085 | 43 | 6 | 5 | 4810 | 9800 |
| | 5600 | 220 | 2585 | 102 | 7030 | 277 | 1235 | 49 | 6 | 5 | 4660 | 9500 |
| | 6050 | 238 | 2735 | 108 | 7480 | 294 | 1385 | 55 | 6 | 3 | 4480 | 9200 |

Note : Mast Specifications & Rated Capacities are based on standard chassis with pneumatic tire and without side shifter.



B40X-7 / B45X-7 / B50XC-7 / B50X-7

7 SERIES FORKLIFTS

Electric 4.0 to 5.0 tonne capacity
4 wheel



Doosan Industrial Vehicle
Web site : www.doosanft.com

2018 Nov

AUTHORIZED DEALER

Technical Data according to VDI 2198

| | | | | | |
|-----------------|---|--|---|---------------|------------------|
| Characteristics | 1.1 | Manufacturer | | DOOSAN | |
| | 1.2 | Manufacturer's type designation | | B40X-7 | |
| | 1.3 | Drive : electric(battery or mains) ,diesel, petrol ,fuel gas, manual | | Electric | |
| | 1.4 | Operator type : hand, pedestrian, standing, seated, order-picker | | Driver seated | |
| | 1.5 | Load capacity/rated load | kg | Q | 4000 |
| | 1.6 | Load centre distance | mm | c | 500 |
| | 1.8 | Load distance, centre of drive axle to fork | mm | x | 572 |
| | 1.9 | Wheelbase | mm | y | 2000 |
| | Weights | 2.1 | Service weight (with min. weight of battery) | kg | 7012 |
| 2.2 | | Axle loading, loaded front/rear | kg | 9874 / 1138 | |
| 2.3 | | Axle loading, unloaded front/rear | kg | 3730 / 3282 | |
| Wheels & Tyres | 3.1 | Tires: pneumatic (P), superelastic (SE), cushion (C) | | SE | |
| | 3.2 | Tire size, front | | 250 - 15 | |
| | 3.3 | Tire size, rear | | 7.00 - 12 | |
| | 3.5 | Wheels, number front/rear (x=driven wheels) | | 2/2 | |
| | 3.6 | Tread width, front | mm | b10 | 1168 |
| | 3.7 | Tread width, rear | mm | b11 | 1111 |
| | Basic dimensions | 4.1 | Tilt of mast/fork carriage forward (α)/backward(β) | deg | α / β |
| 4.2 | | Height, mast lowered | mm | h1 | 2330 |
| 4.3 | | Free lift | mm | h2 | 150 |
| 4.4 | | Lift (with STD 2-stage mast) | mm | h3 | 3250 |
| | | Lift height | | h23 | 3300 |
| 4.5 | | Height, mast extended | mm | h4 | 4170 |
| 4.7 | | Height to top of overhead guard | mm | h6 | 2345 |
| 4.8 | | Seat height/stand height | mm | h7 | 1297 |
| 4.12 | | Towing coupling height | mm | h10 | 415 |
| 4.19 | | Overall length | mm | l1 | 4007 |
| 4.20 | | Length to face of forks | mm | l2 | 2957 |
| 4.21 | | Overall width | mm | b1 | 1470 |
| 4.22 | | Fork dimensions | mm | s / e / l | 50 / 150 / 1050 |
| 4.23 | | Fork carriage ISO 2328. Class/type A, B | | | III A |
| 4.24 | | Fork carriage width | mm | b3 | 1250 |
| 4.24a | | Fork Spacing (min/max) | mm | | 310 x 1182 |
| 4.31 | | Ground clearance, with load, below mast | mm | m1 | 120 |
| 4.32 | | Ground clearance, centre of wheelbase | mm | m2 | 160 |
| 4.34.1 | | Aisle width for pallets 1000 x 1200 crossways | mm | Ast | 4416 |
| 4.34.1 | Aisle width for pallets 800 x 1200 lengthways | mm | Ast | 4655 | |
| 4.35 | Turning radius | mm | Wa | 2620 | |
| 4.36 | Internal turning radius | mm | b13 | 877 | |
| Performance | 5.1 | Travel speed, loaded / unloaded | km/h | 15 / 16 | |
| | 5.2 | Lift speed, loaded / unloaded | mm/s | 350 / 470 | |
| | 5.3 | Lowering speed, loaded / unloaded | mm/s | 480 / 450 | |
| | 5.6 | Maximum drawbar pull, loaded / unloaded, 5 minute rating | N | 18620 / 18620 | |
| | 5.8 | Maximum gradeability, loaded / unloaded, 5 minute rating | % | 17 / 27 | |
| | 5.10 | Service brake | | FOOT / HYD | |
| | Parking brake | | HAND / MECH | | |
| Electric | 6.1 | Drive motor rating S2 60 minute | kW | 10(13) X 2 | |
| | 6.2 | Lifting motor rating at S3 15% | kW | 28 | |
| | 6.3 | Battery as per DIN 43531 /35/36 A, B, C, no | | DIN43536A | |
| | 6.4 | Battery voltage/nominal capacity K5 | V/Ah | 80 / 720 | |
| | 6.5 | Battery weight (min) | kg | 2160 | |
| | Battery dimensions L/W/H | mm | 990 / 1028 / 784 | | |
| Others | 8.1 | Type of drive control unit | | Inverter AC | |
| | 8.2 | Working press for attachments | System | 190 | |
| | | | Attachment | 155 | |
| | 8.4 | Sound level at the driver's ear according to EN 12 053 | dB | | 70 |

| | | |
|------------------|------------------|------------------|
| DOOSAN | DOOSAN | DOOSAN |
| B45X-7 | B50XC-7 | B50X-7 |
| Electric | Electric | Electric |
| Driver seated | Driver Seated | Driver Seated |
| 4500 | 4990 | 5000 |
| 500 | 500 | 500 |
| 572 | 572 | 572 |
| 2000 | 2000 | 2000 |
| 7427 | 7734 | 7763 |
| 10607 / 1320 | 11415 / 1318 | 11450 / 1312 |
| 3695 / 3732 | 3735 / 3998 | 3770 / 3992 |
| SE | SE | SE |
| 28 x 12.5 - 15 | 28 x 12.5 - 15 | 28 x 12.5 - 15 |
| 7.00 - 12 | 7.00 - 12 | 7.00 - 12 |
| 2/2 | 2/2 | 2/2 |
| 1160 | 1160 | 1160 |
| 1111 | 1111 | 1111 |
| 6 / 9 | 6 / 9 | 6 / 9 |
| 2340 | 2340 | 2340 |
| 160 | 160 | 160 |
| 3250 | 3250 | 3250 |
| 3300 | 3300 | 3300 |
| 4180 | 4180 | 4205 |
| 2350 | 2350 | 2350 |
| 1303 | 1303 | 1303 |
| 415 | 415 | 415 |
| 4007 | 4037 | 4037 |
| 2957 | 2987 | 2987 |
| 1470 | 1470 | 1470 |
| 50 / 150 / 1050 | 50 / 150 / 1050 | 50 / 150 / 1050 |
| III A | III A | IV A |
| 1250 | 1250 | 1330 |
| 310 x 1182 | 310 x 1182 | 340 x 1290 |
| 130 | 130 | 130 |
| 160 | 160 | 160 |
| 4417 | 4442 | 4442 |
| 4656 | 4681 | 4681 |
| 2620 | 2645 | 2645 |
| 879 | 879 | 879 |
| 15 / 16 | 15 / 16 | 15 / 16 |
| 330 / 470 | 310 / 470 | 310 / 470 |
| 480 / 450 | 480 / 450 | 480 / 450 |
| 18620 / 18620 | 18620 / 18620 | 18620 / 18620 |
| 16 / 26 | 15 / 25 | 15 / 25 |
| FOOT / HYD | FOOT / HYD | FOOT / HYD |
| HAND / MECH | HAND / MECH | HAND / MECH |
| 10(13) X 2 | 10(13) X 2 | 10(13) X 2 |
| 28 | 28 | 28 |
| DIN43536A | DIN43536A | DIN43536A |
| 80 / 720 | 80 / 720 | 80 / 720 |
| 2160 | 2160 | 2160 |
| 990 / 1028 / 784 | 990 / 1028 / 784 | 990 / 1028 / 784 |
| Inverter AC | Inverter AC | Inverter AC |
| 210 | 230 | 230 |
| 155 | 155 | 155 |
| 70 | 70 | 70 |

Dimensional Drawing

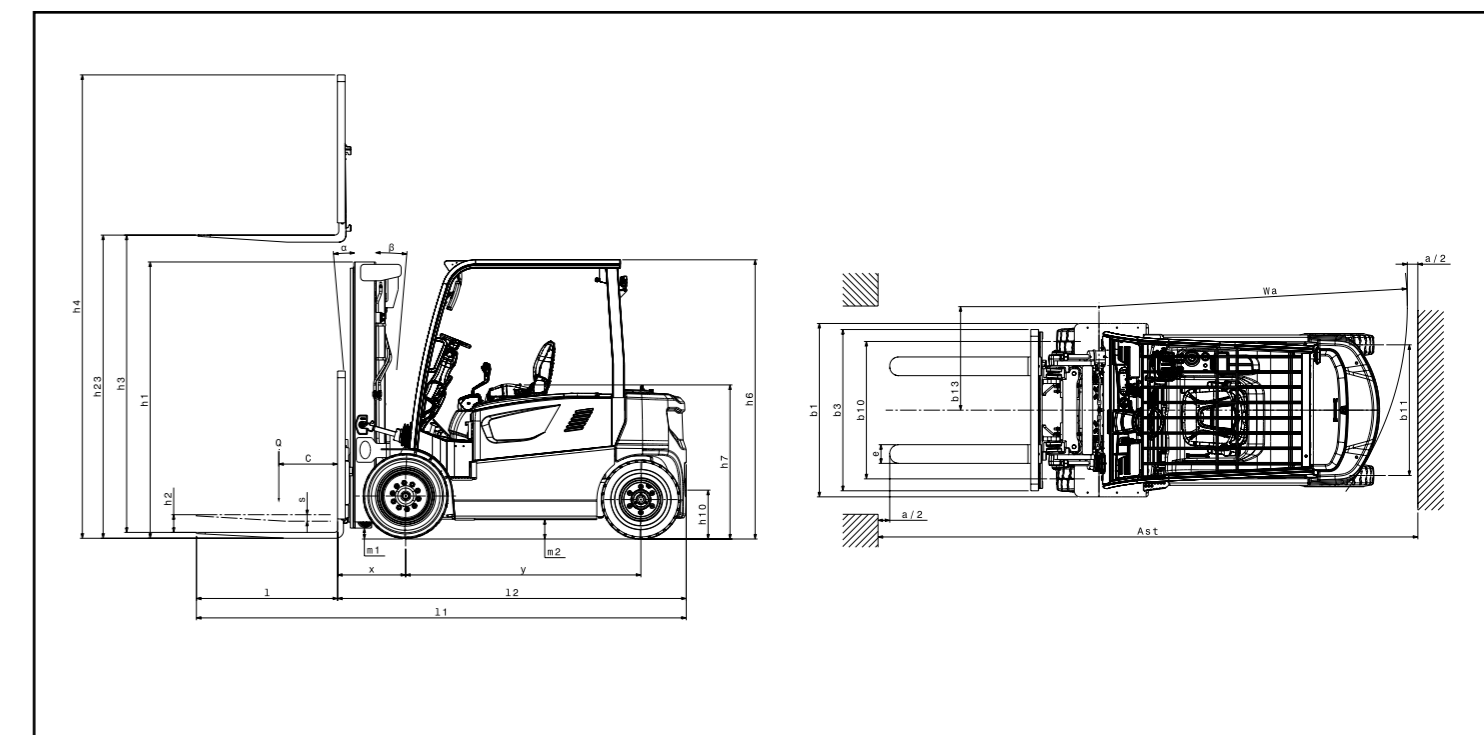

Doosan Industrial Vehicle
Web site : www.doosanflt.com